

# **PALAZZO LOMBARDIA**

Piazza Città di Lombardia 1 - MILANO

Nelle planimetrie sono indicate le aree break esistenti con lo spazio attrezzato per i distributori e dispenser e i punti esterni alle aree break per il posizionamento di dispenser

Totale aree break 36

Totale dispenser 40

## DISTRIBUZIONE AREE BREAK NEI CORPI BASSI

## MILANO – PALAZZO LOMBARDIA

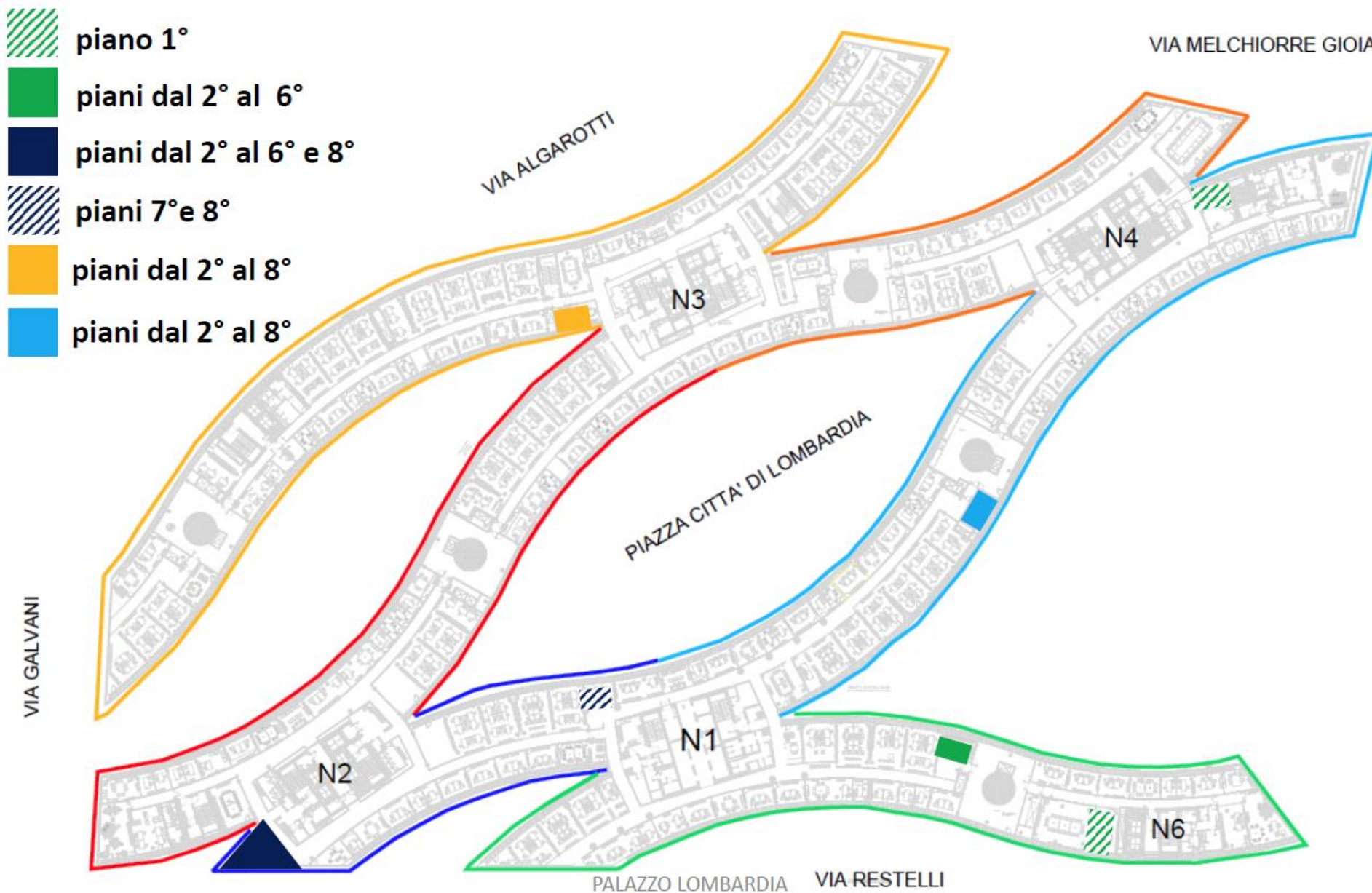

 **piano 8°**

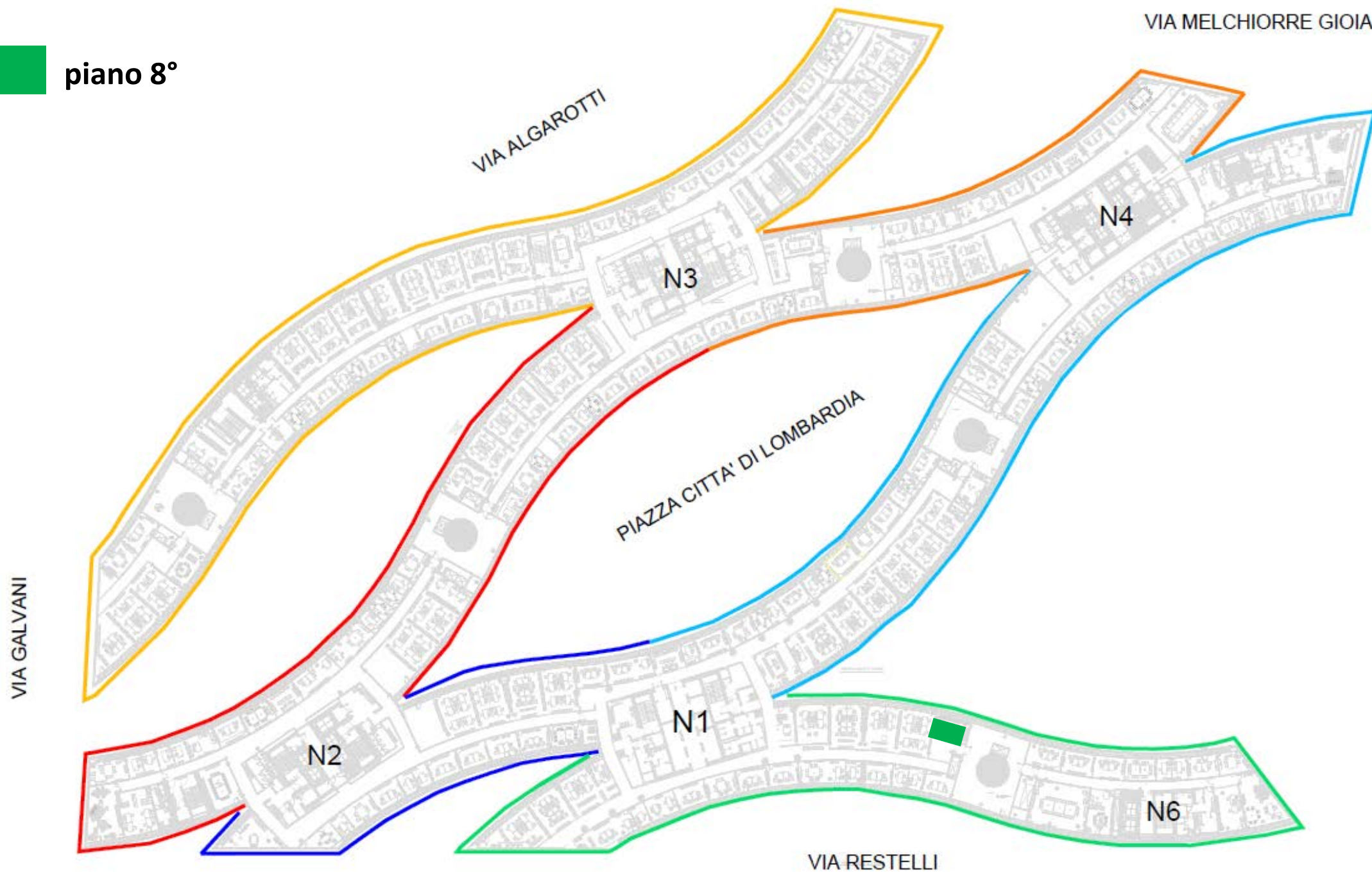



## AREA BREAK SpazioRegione

Piano terra



 area per distributori



## AREA BREAK **AZZURRA**

Piano 1°

 area per distributori e dispenser



## AREA BREAK VERDE

Piani 1°

 area per distributori

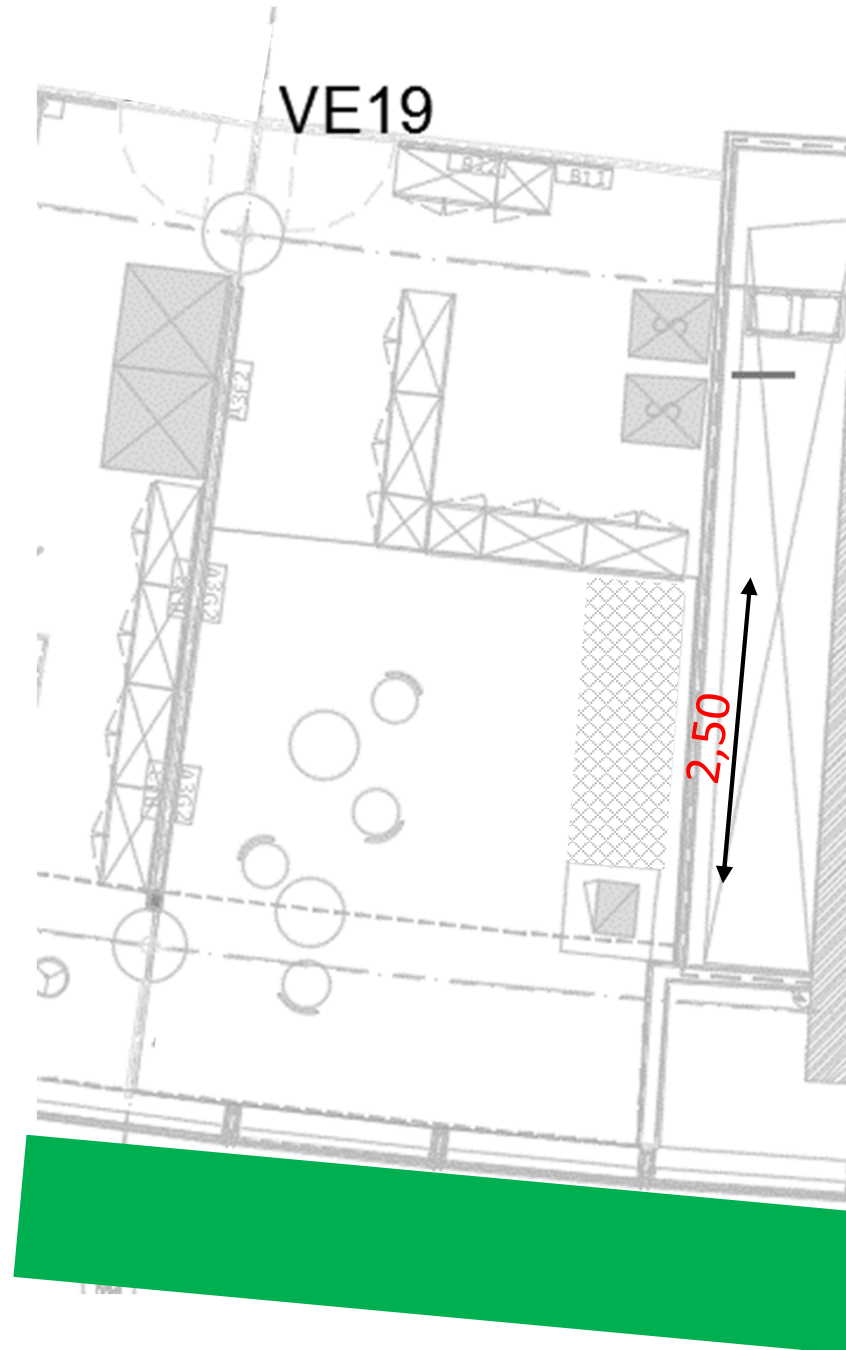

## AREA BREAK **GIALLA**

Piani 2° - 3° - 4° - 5° - 6°

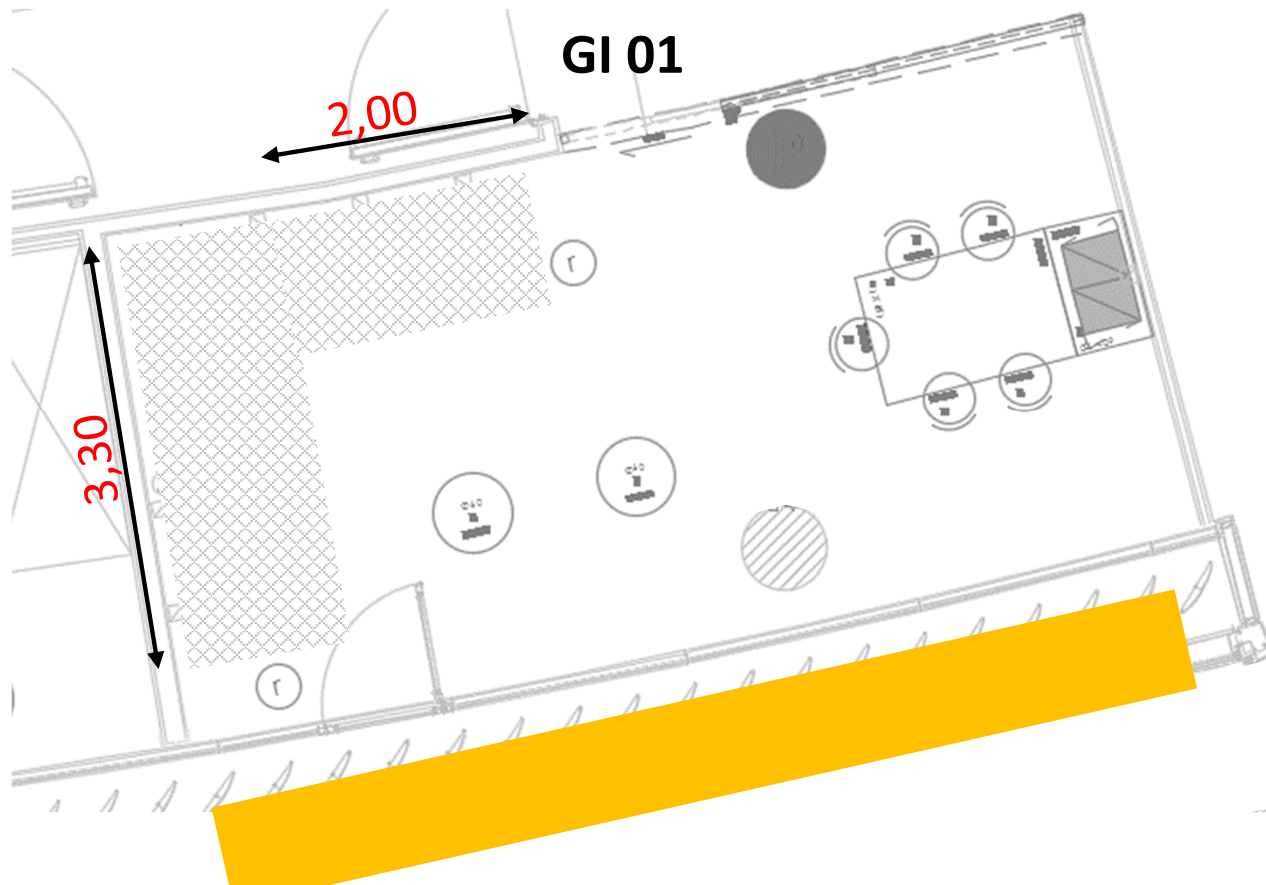

 **area per distributori**



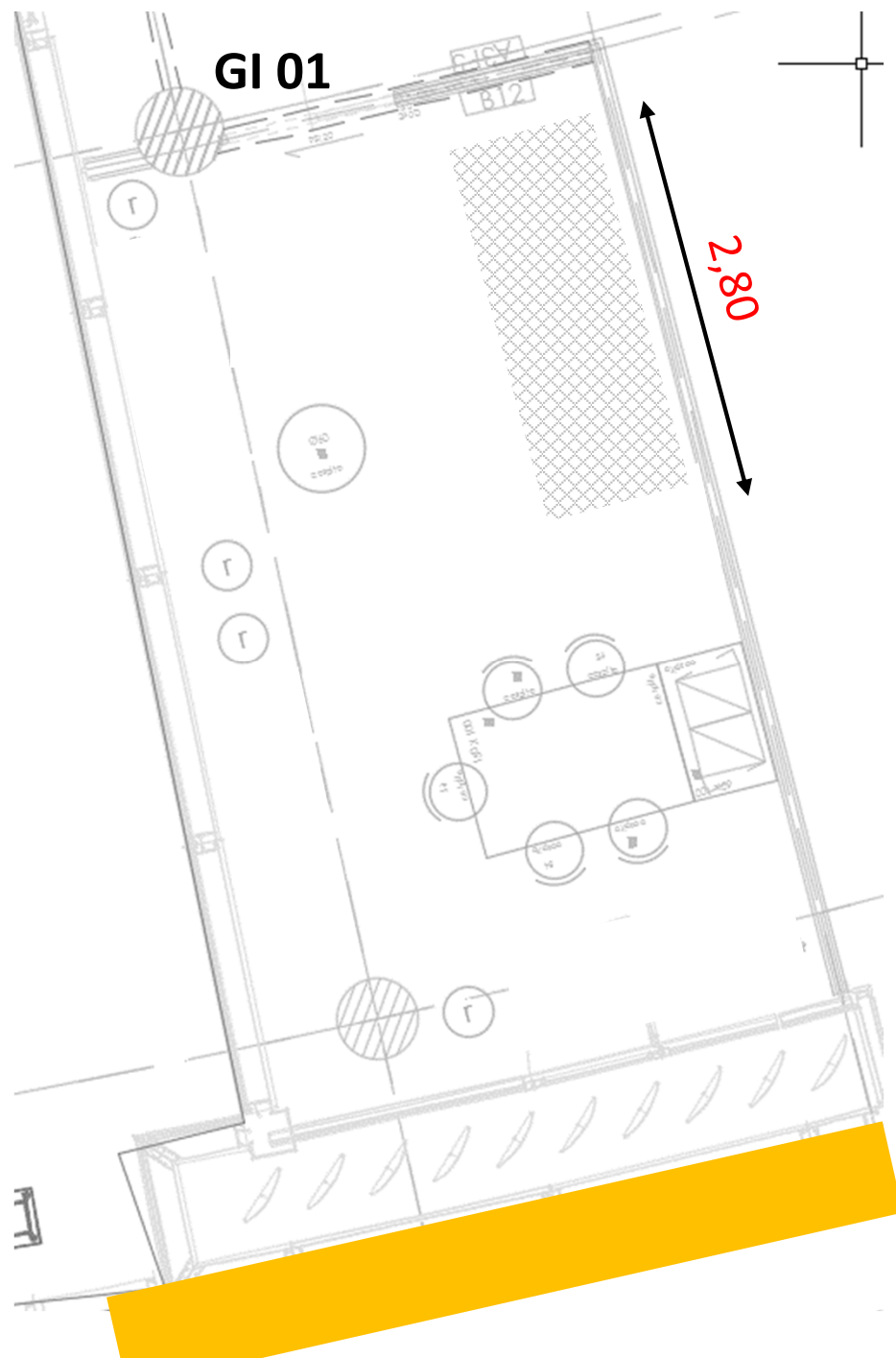

AREA BREAK **GIALLA**

Piani 7° - 8°

 area per distributori

## AREA BREAK **BLU**

Piani 2 - 4° - 6°

 **area per distributori**

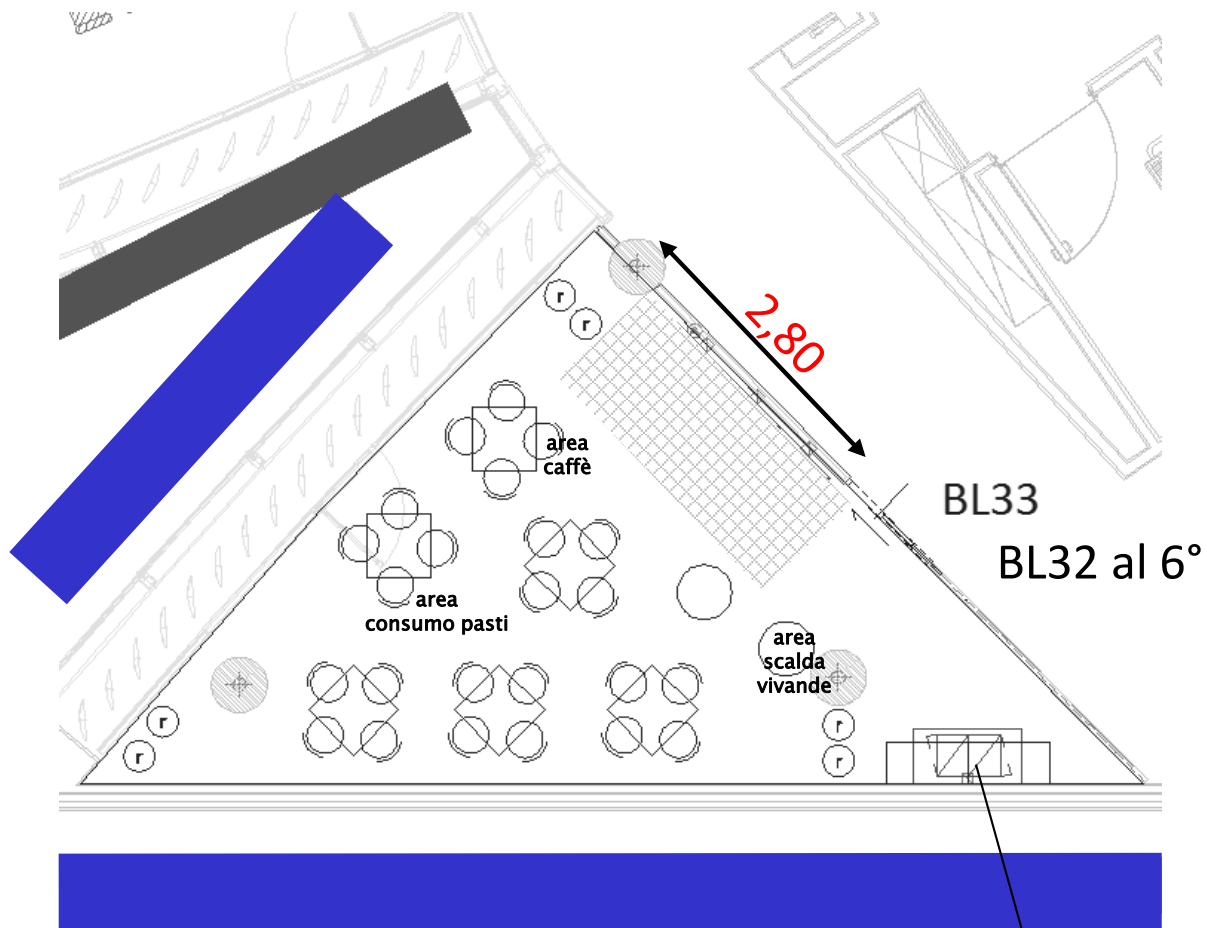

n. 2 microonde sotto  
cappa aspirante

## AREA BREAK **BLU**

Piani 3° - 5°

 **area per distributori**

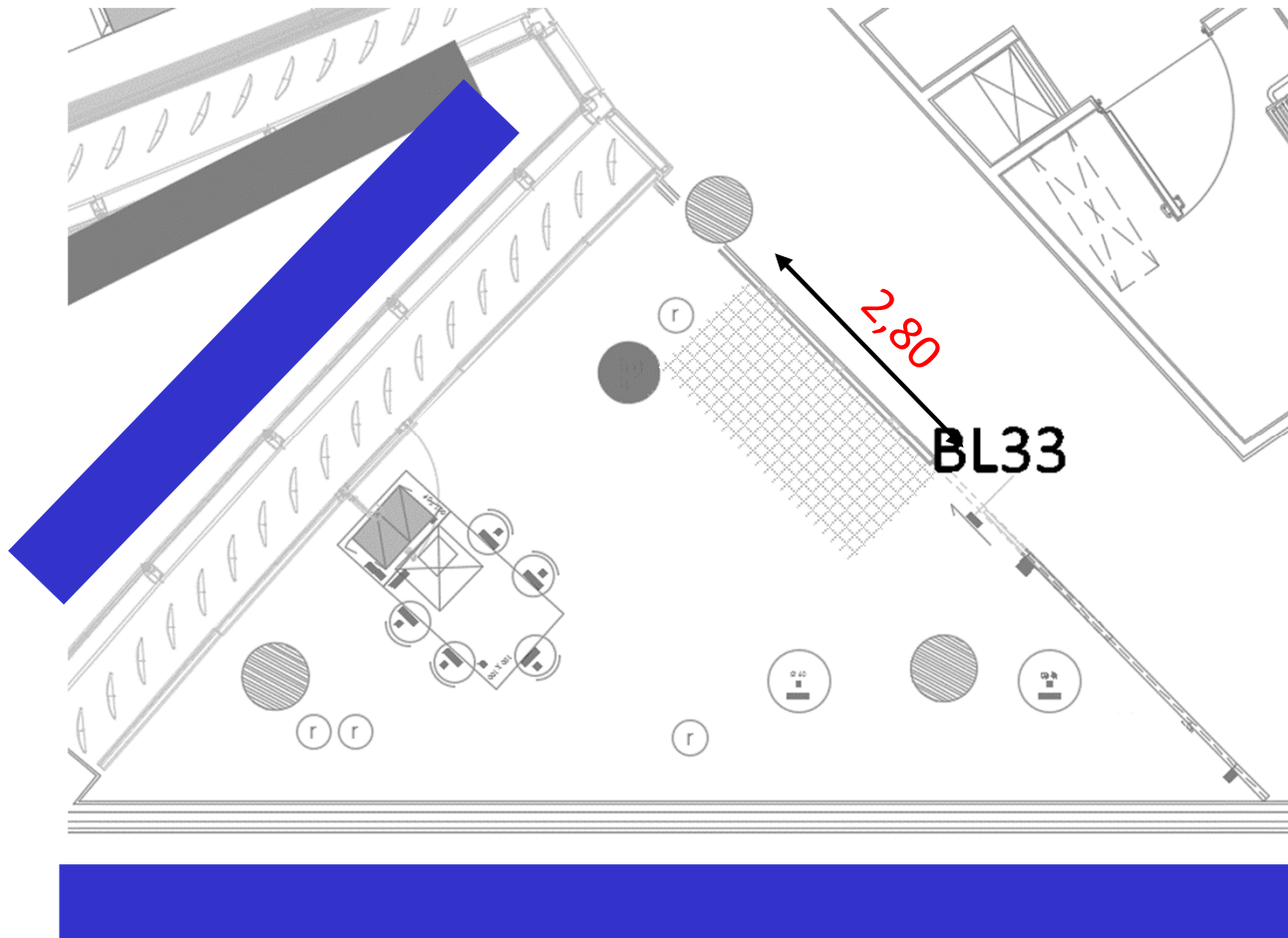



## AREA BREAK **BLU**

Piani 7° - 8°



**area per distributori**

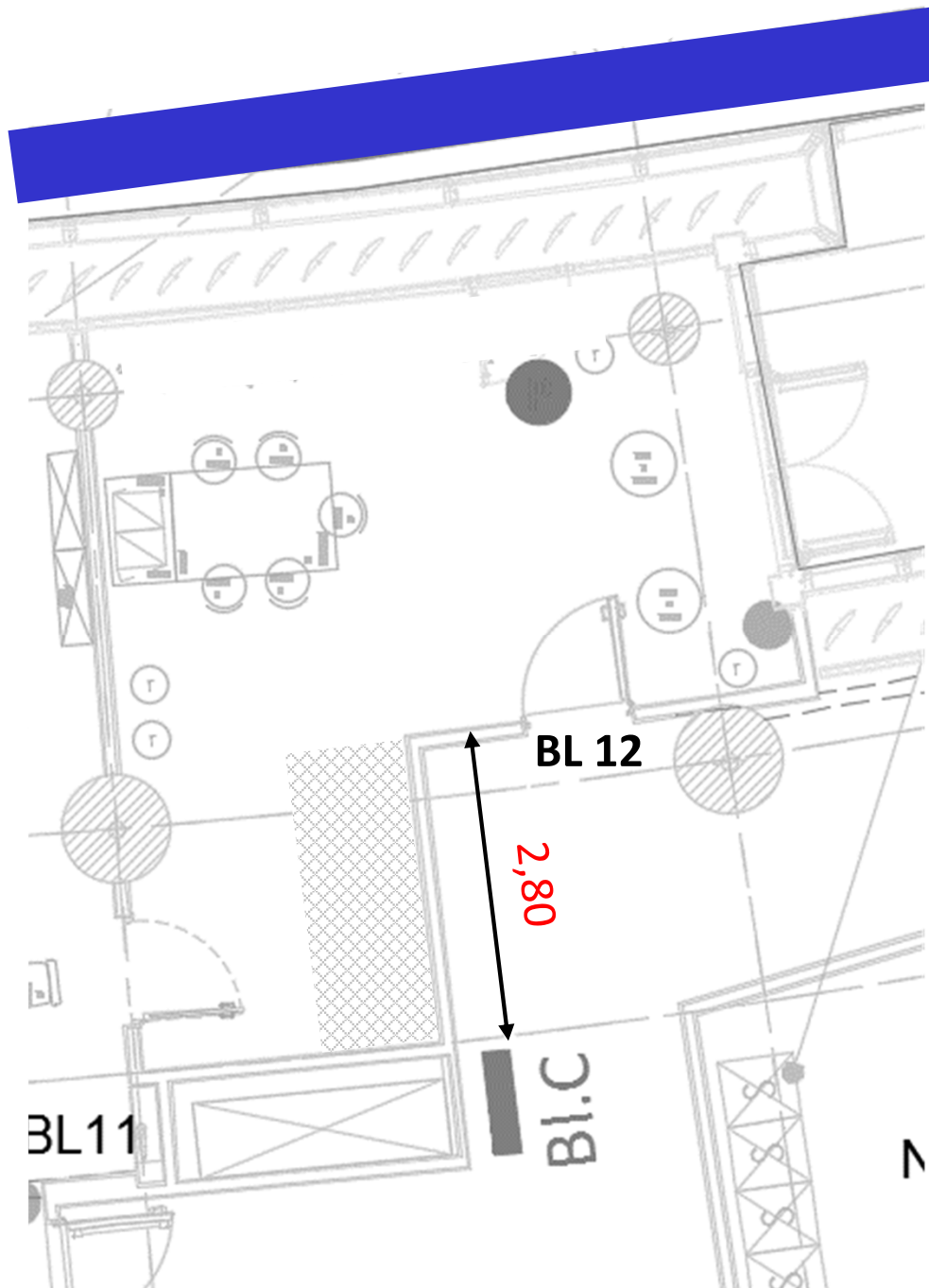

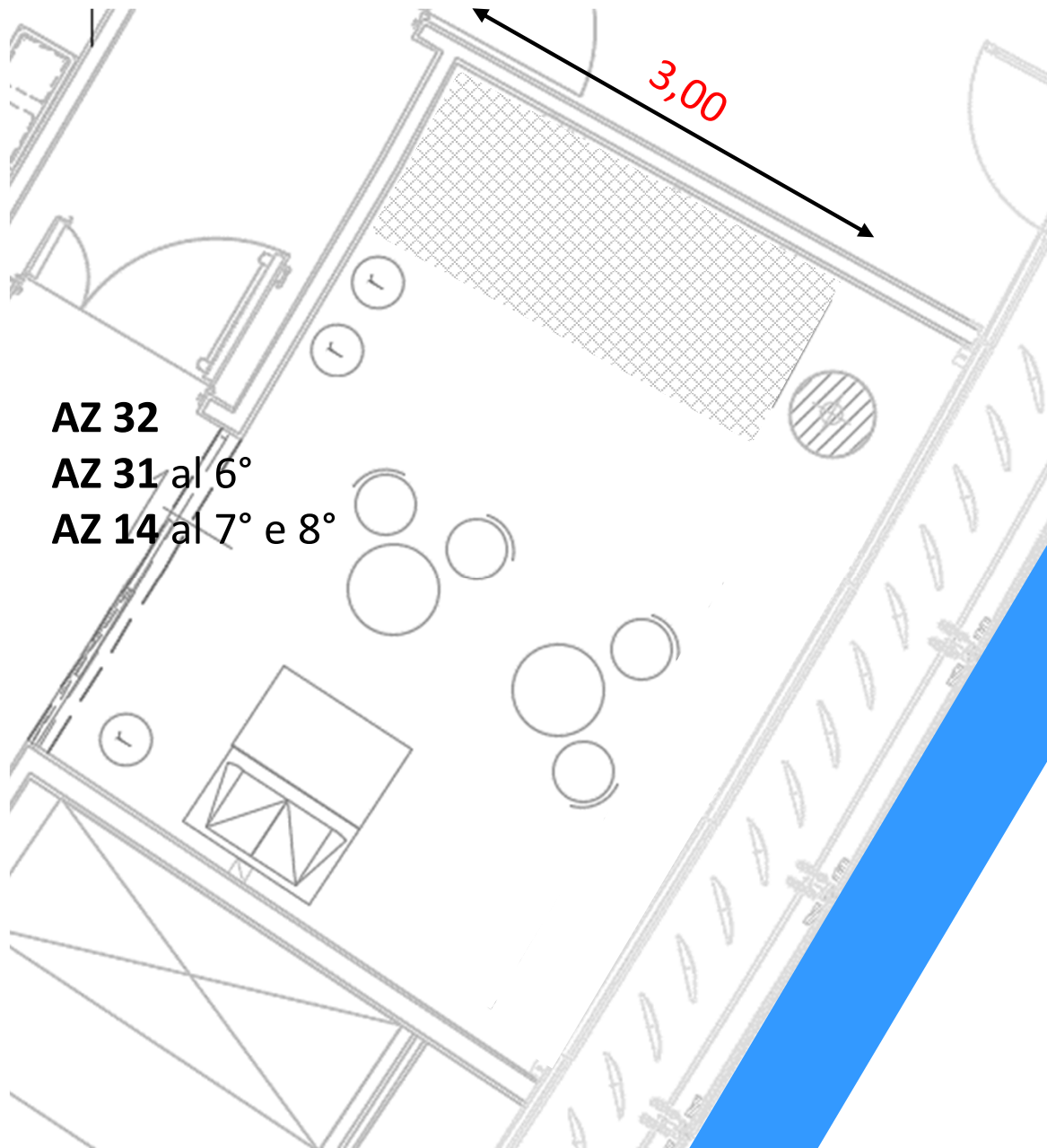

## AREA BREAK **AZZURRA**

Piani 2° - 3° - 4° - 5° - 6° - 7° - 8°



**area per distributori**

## AREA BREAK VERDE

Piani 2° - 3° - 4° - 5° - 6° - 8°

 area per distributori

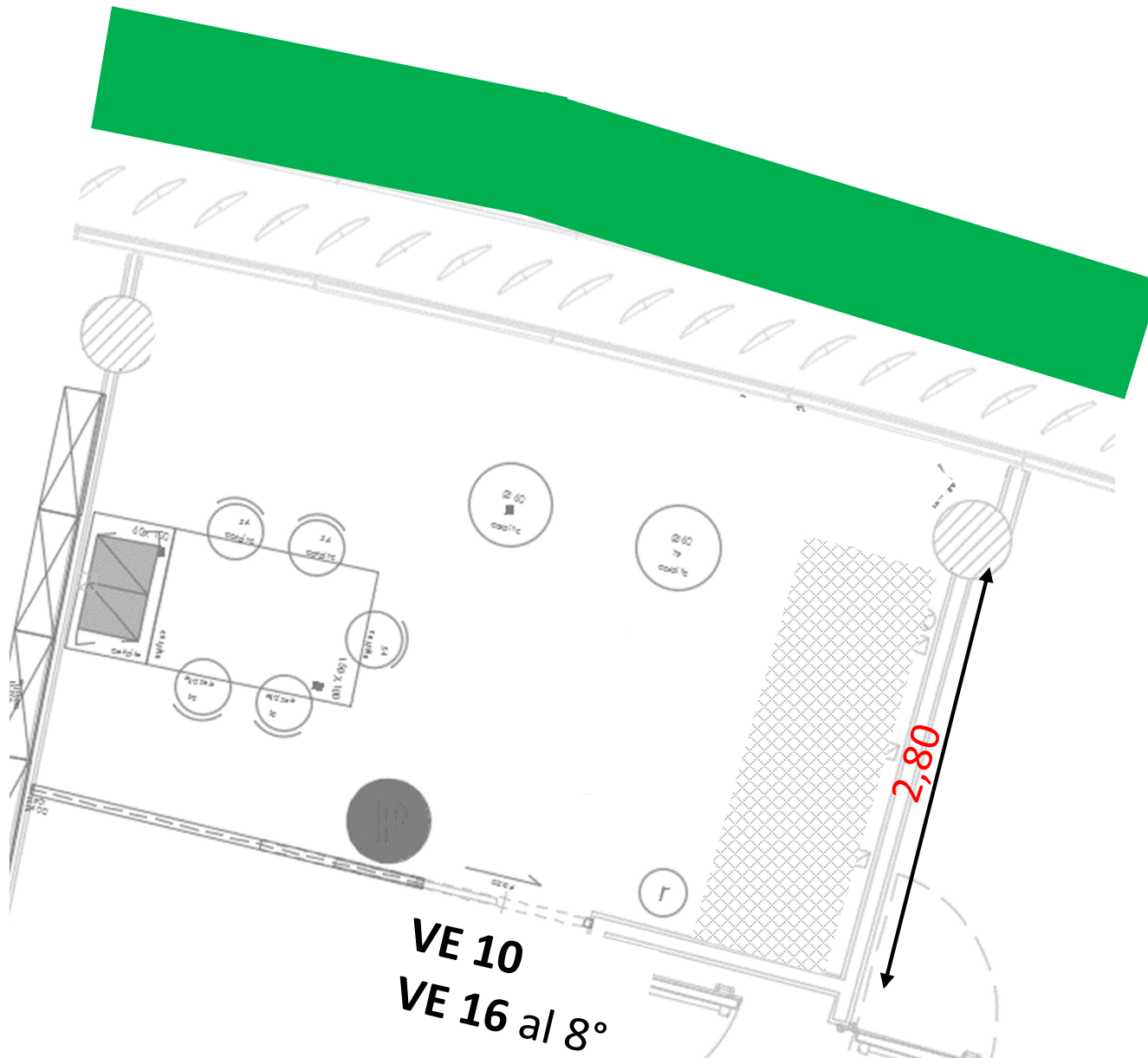





**piano 16°**



**piani 18° - 20° - 22° - 24° - 26°**

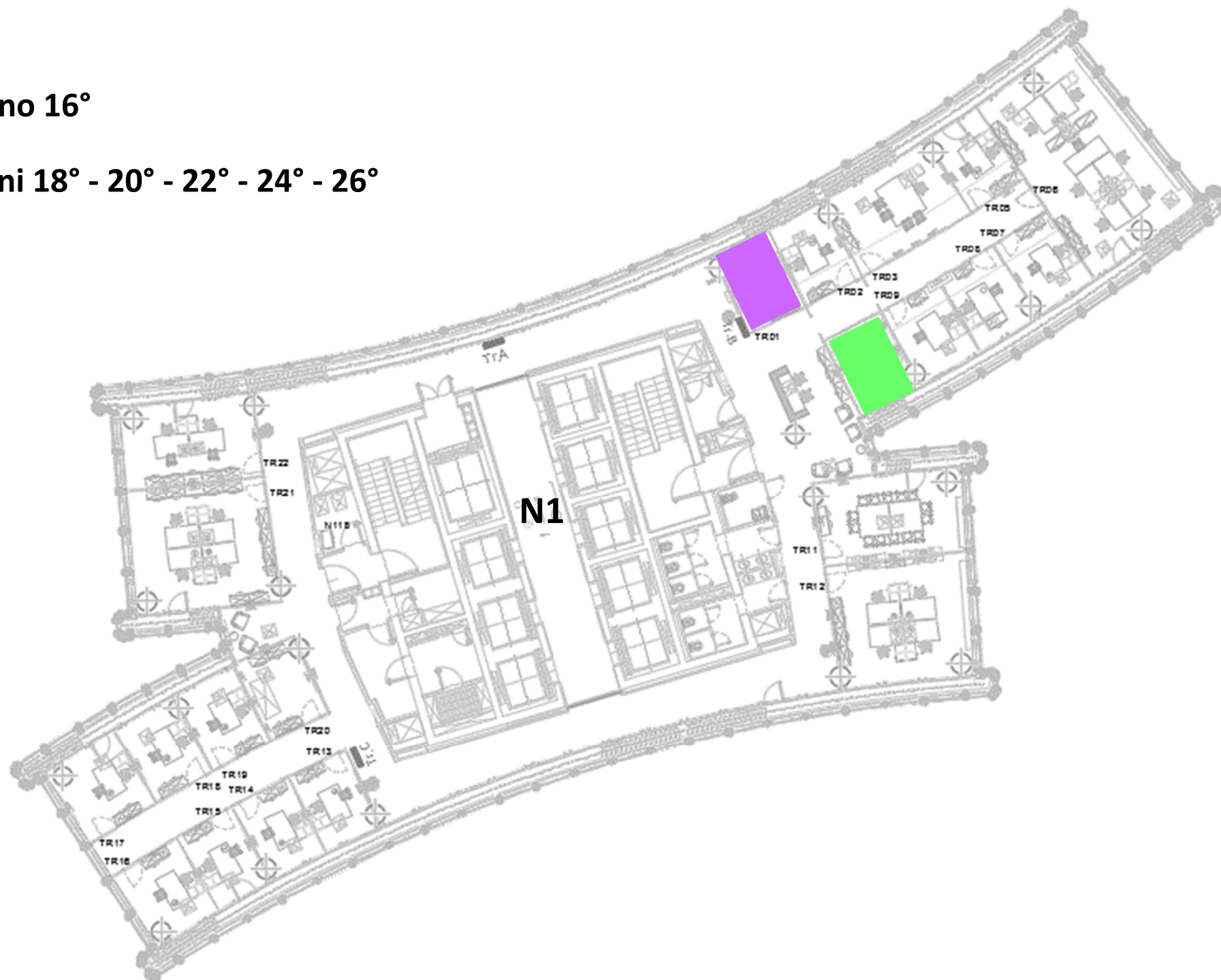

## AREA BREAK **TORRE**

Piano 16°

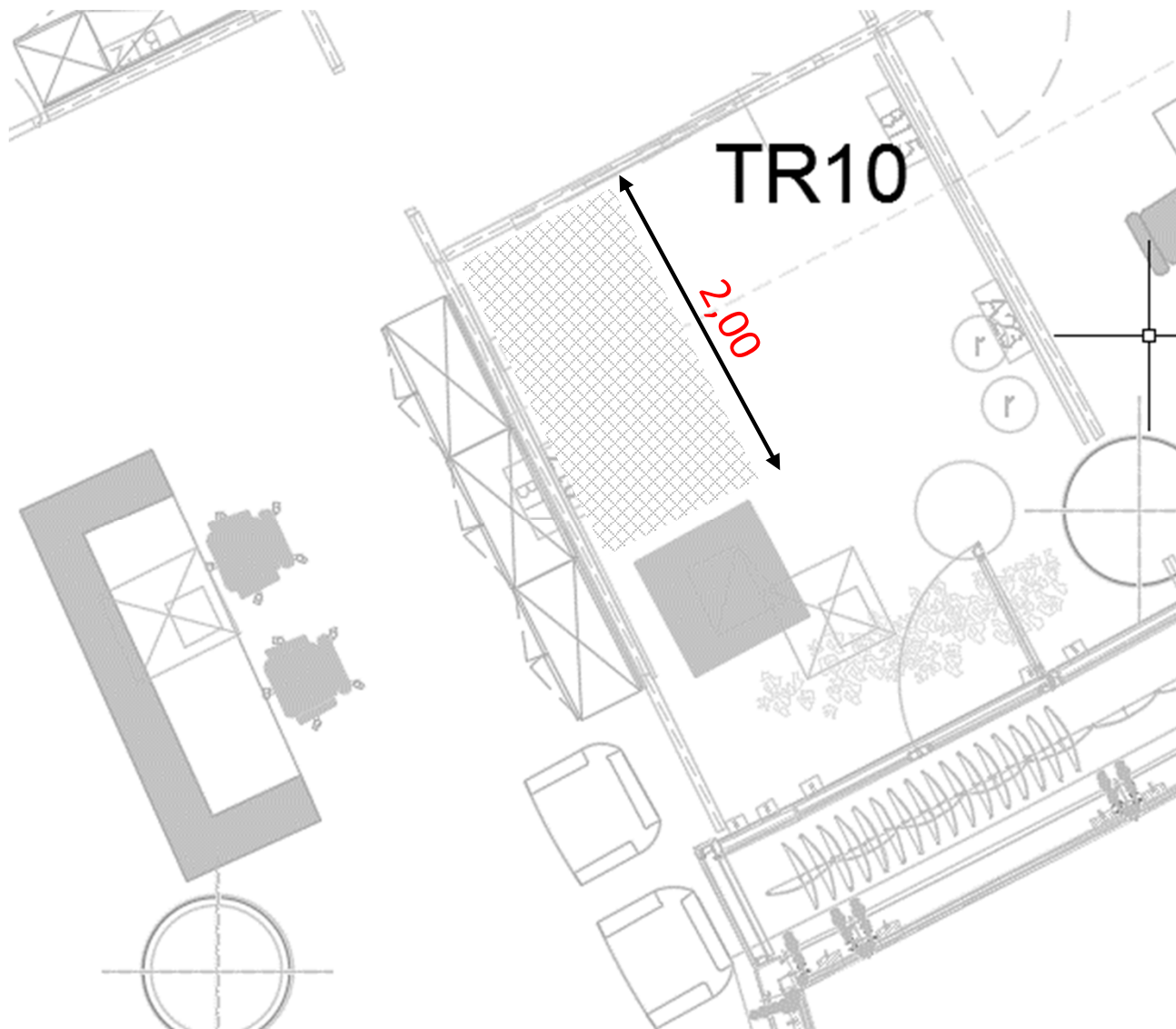

 **area per distributori**

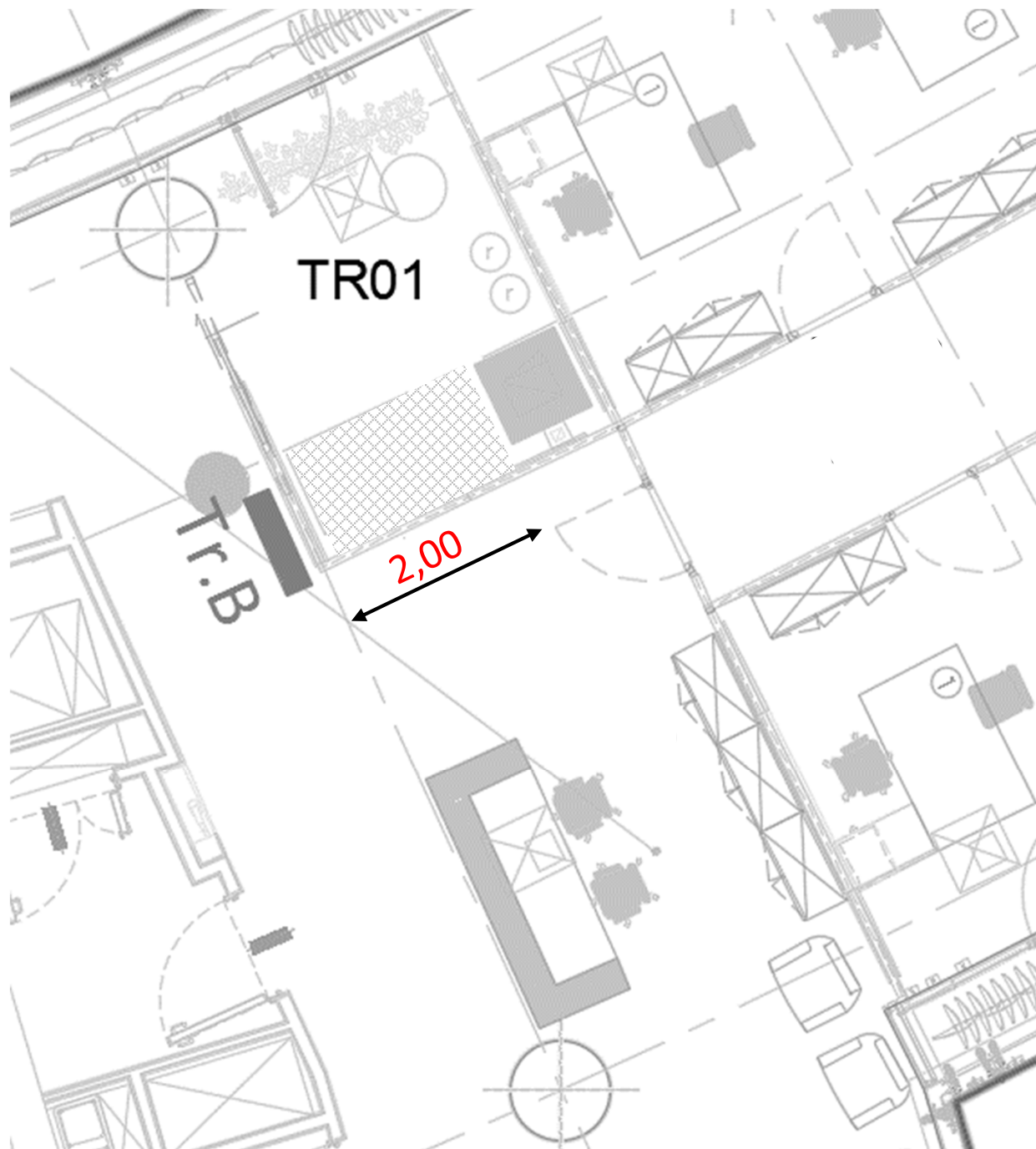

## AREA BREAK **TORRE**

Piano **18° - 20° - 22° - 24° - 26°**



**area per distributori**



# DISTRIBUZIONE DISPENSER NEI CORPI BASSI tot. 17

MILANO – PALAZZO LOMBARDIA

- **piano 1° N1, N4**
- **piani 2°, 4°, 6°, 8° N2 e N4**
- **piani 3°, 5°, 7° N1 e N3**

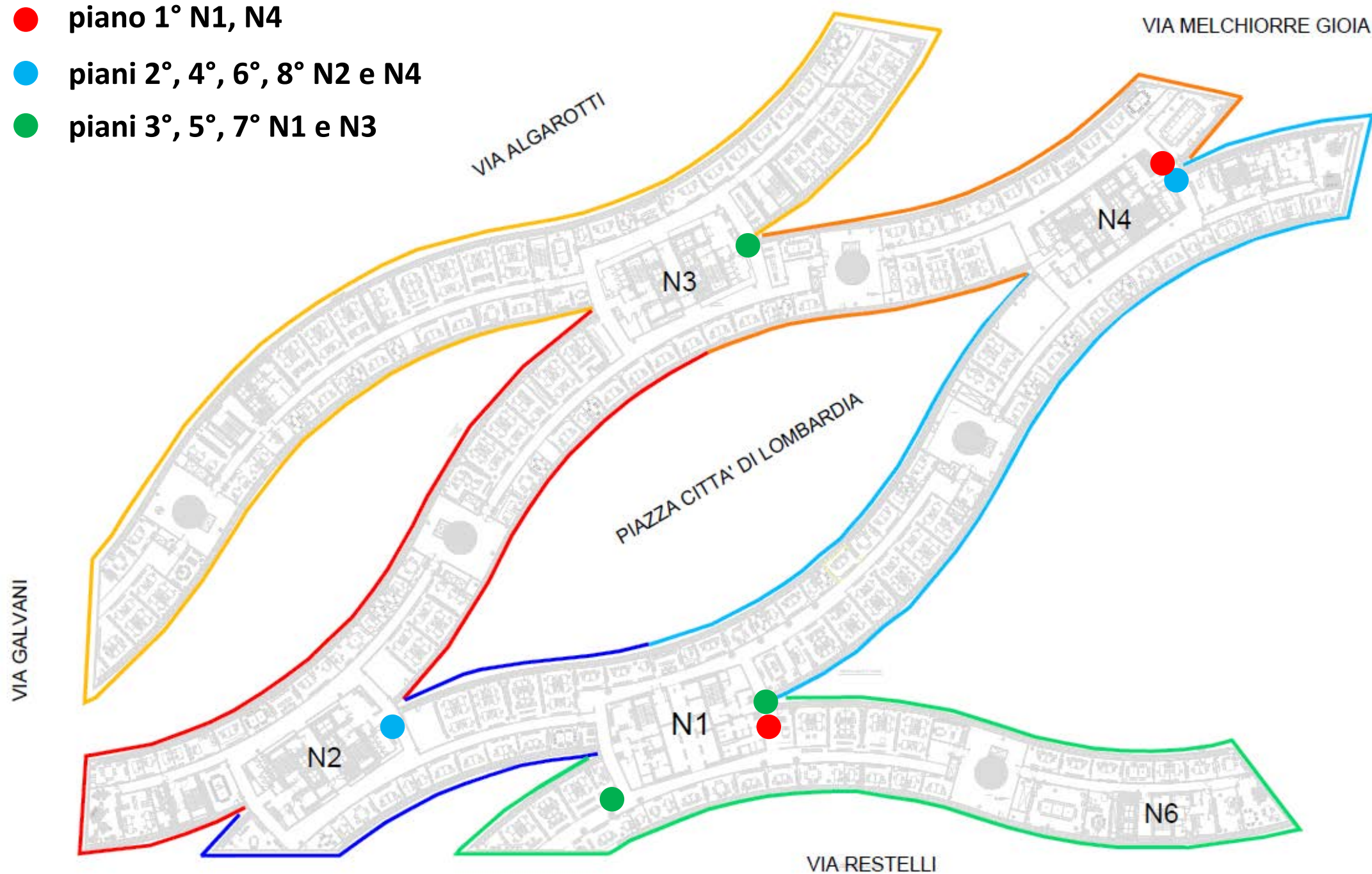

● piani dal 13° al 33°

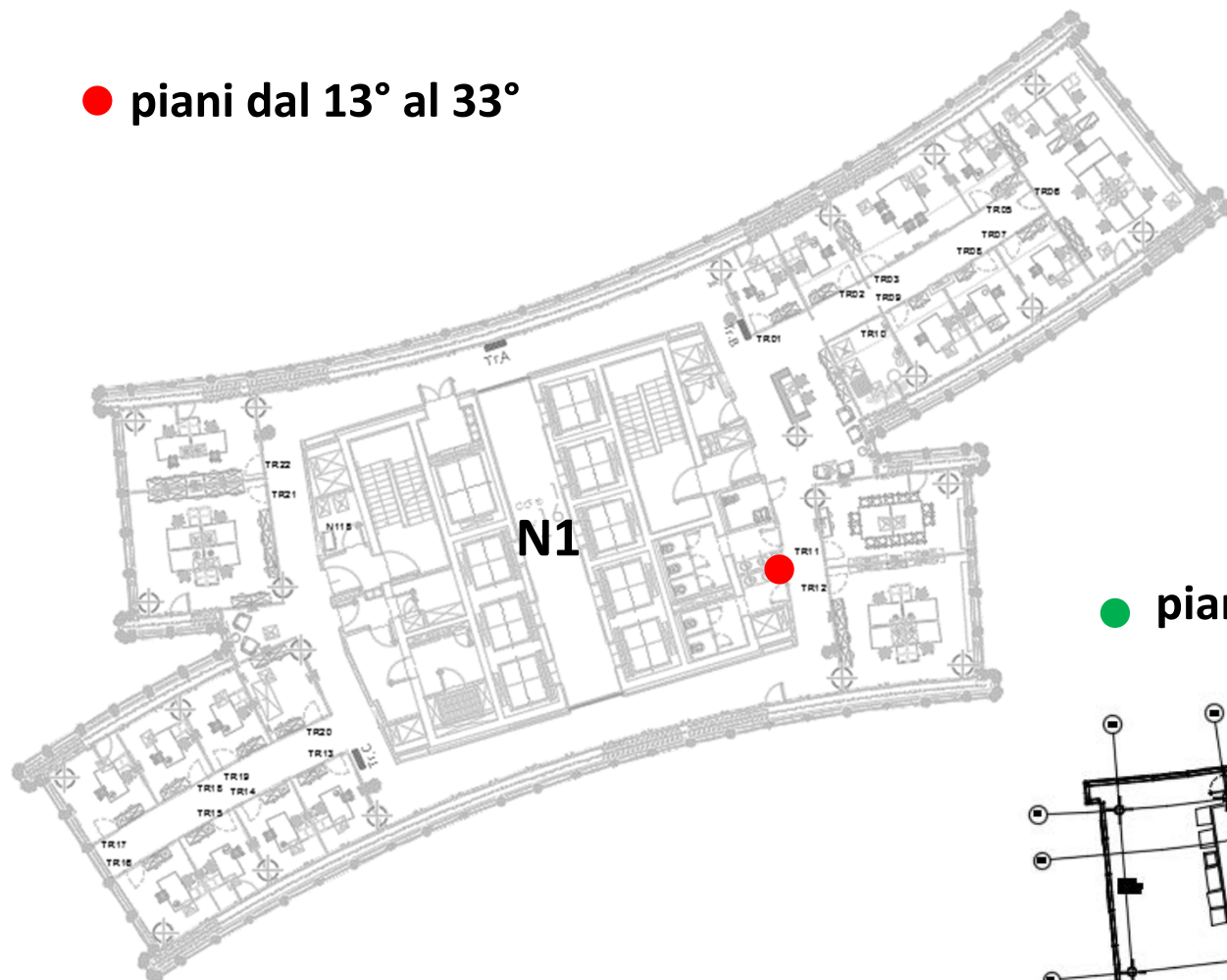

piano 35°



● piano 38°

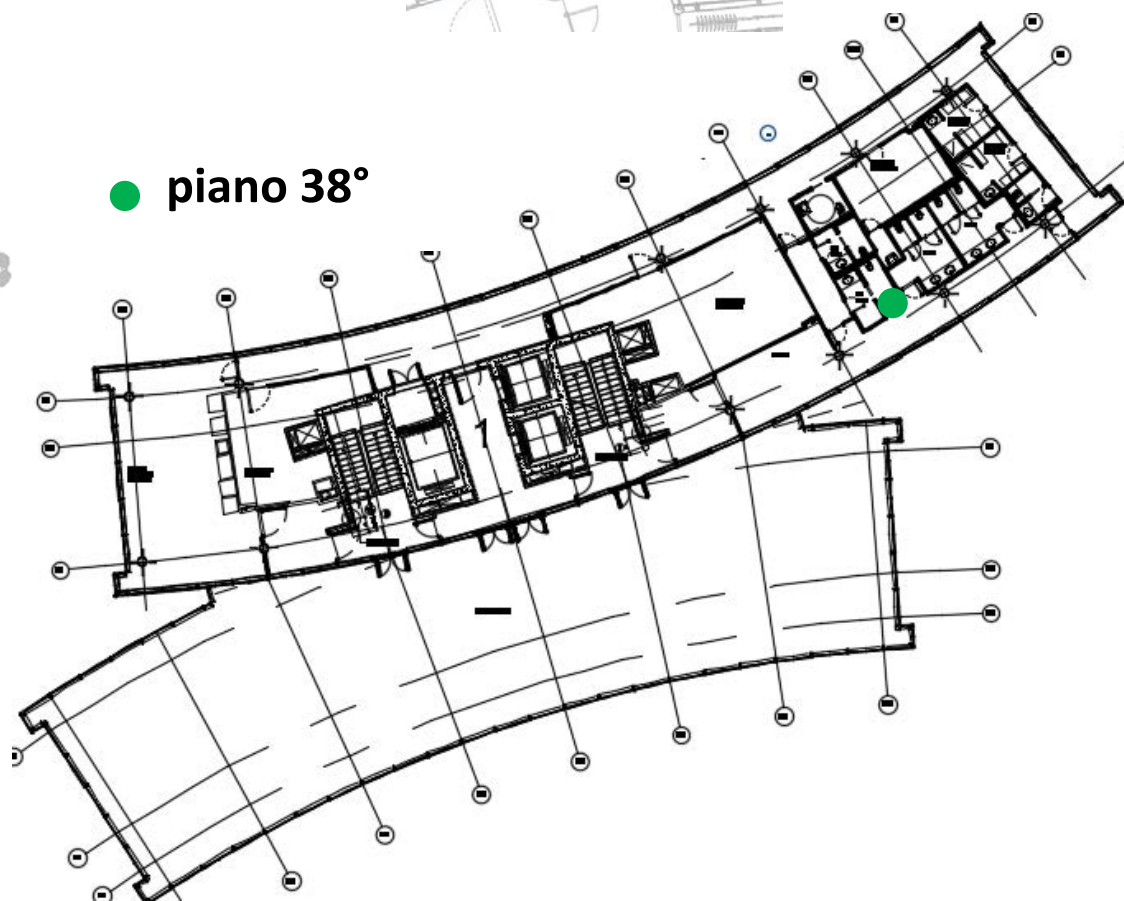

## AREA BREAK **SpazioRegione**

Piano terra

 area per distributori e dispenser





## AREA BREAK **AZZURRA**

Piano 1°

 area per distributori e dispenser

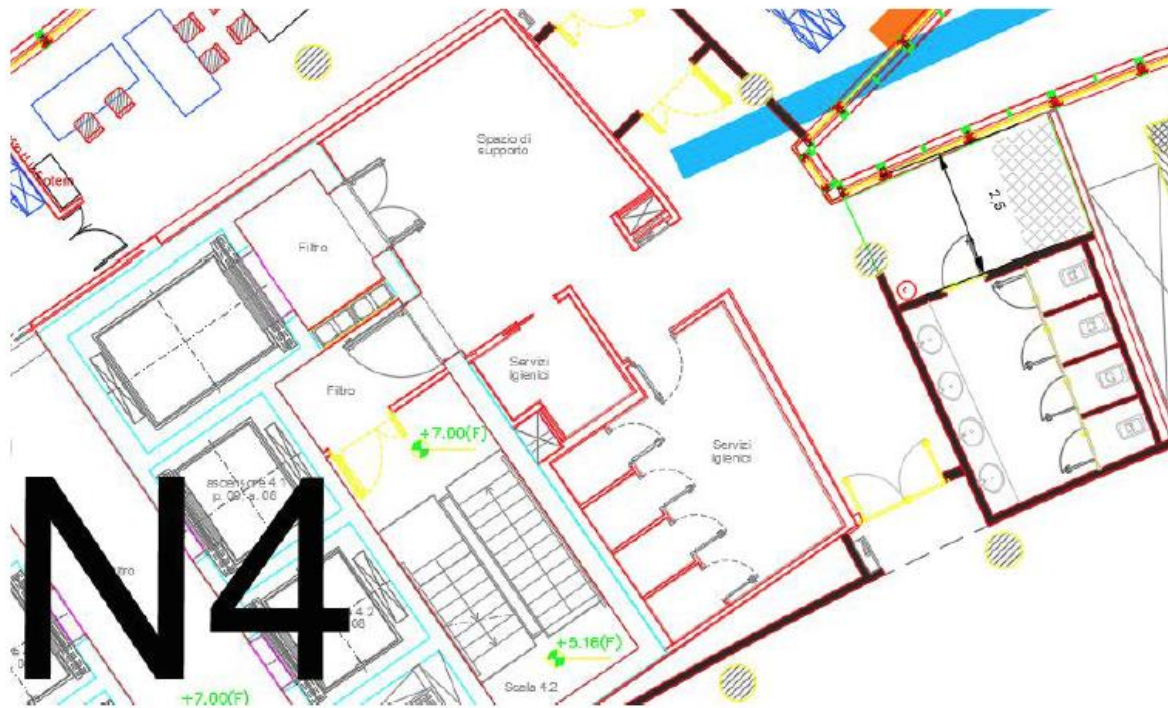

PALAZZO LOMBARDIA

## AREA BREAK VERDE

Piani 1°

 area per distributori e dispenser

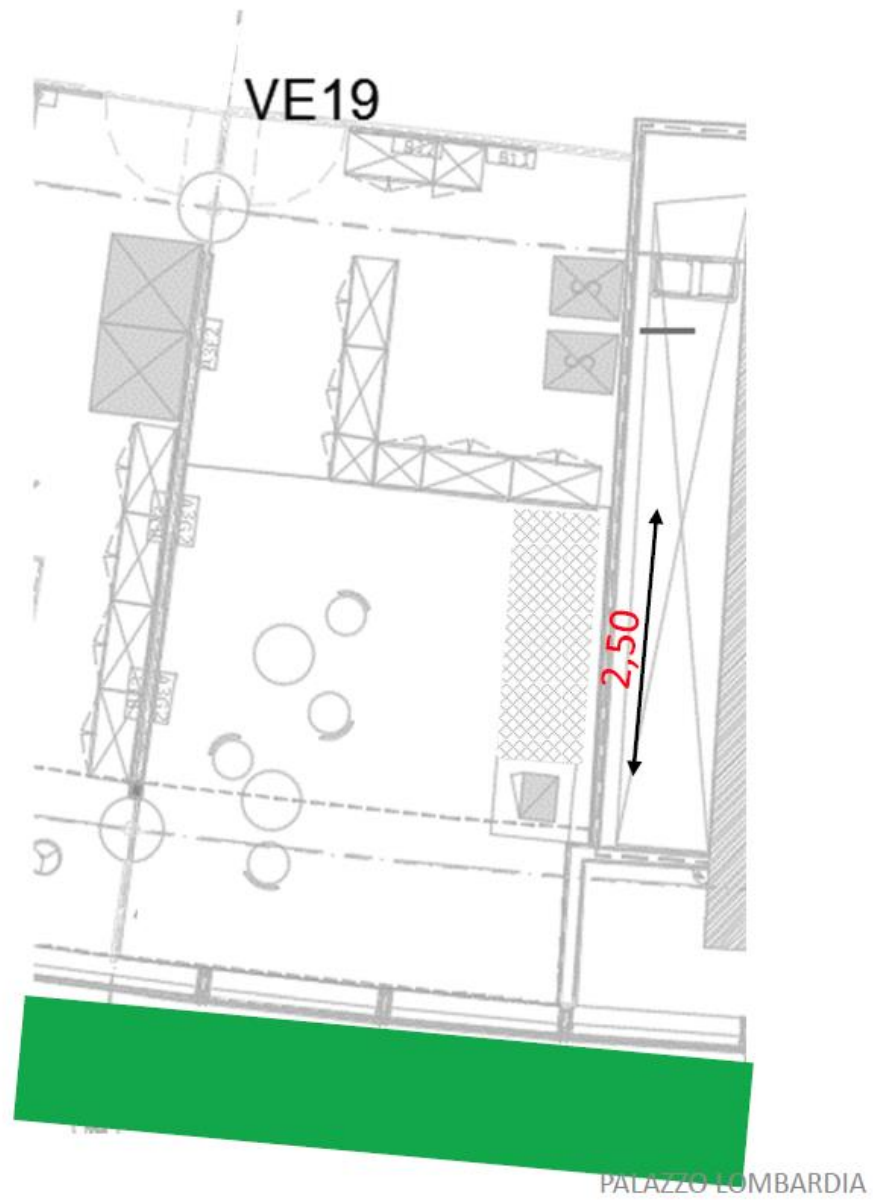

## AREA BREAK **GIALLA**

Piani 2° - 3° - 4° - 5° - 6°

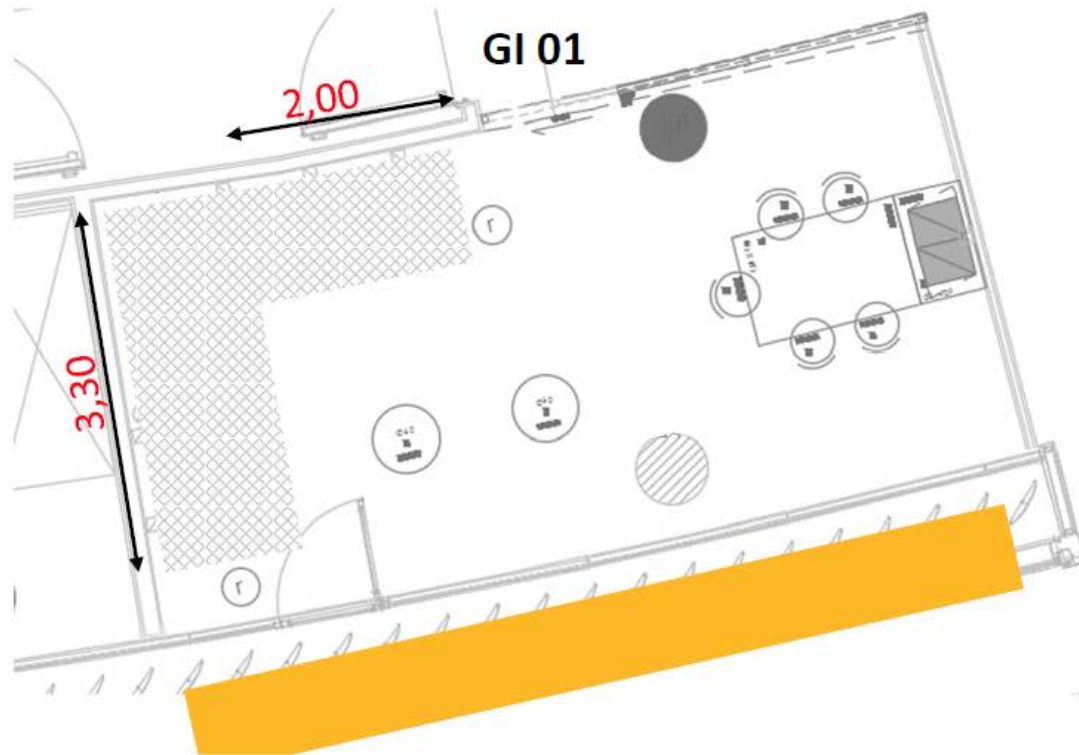

 **area per distributori e dispenser**



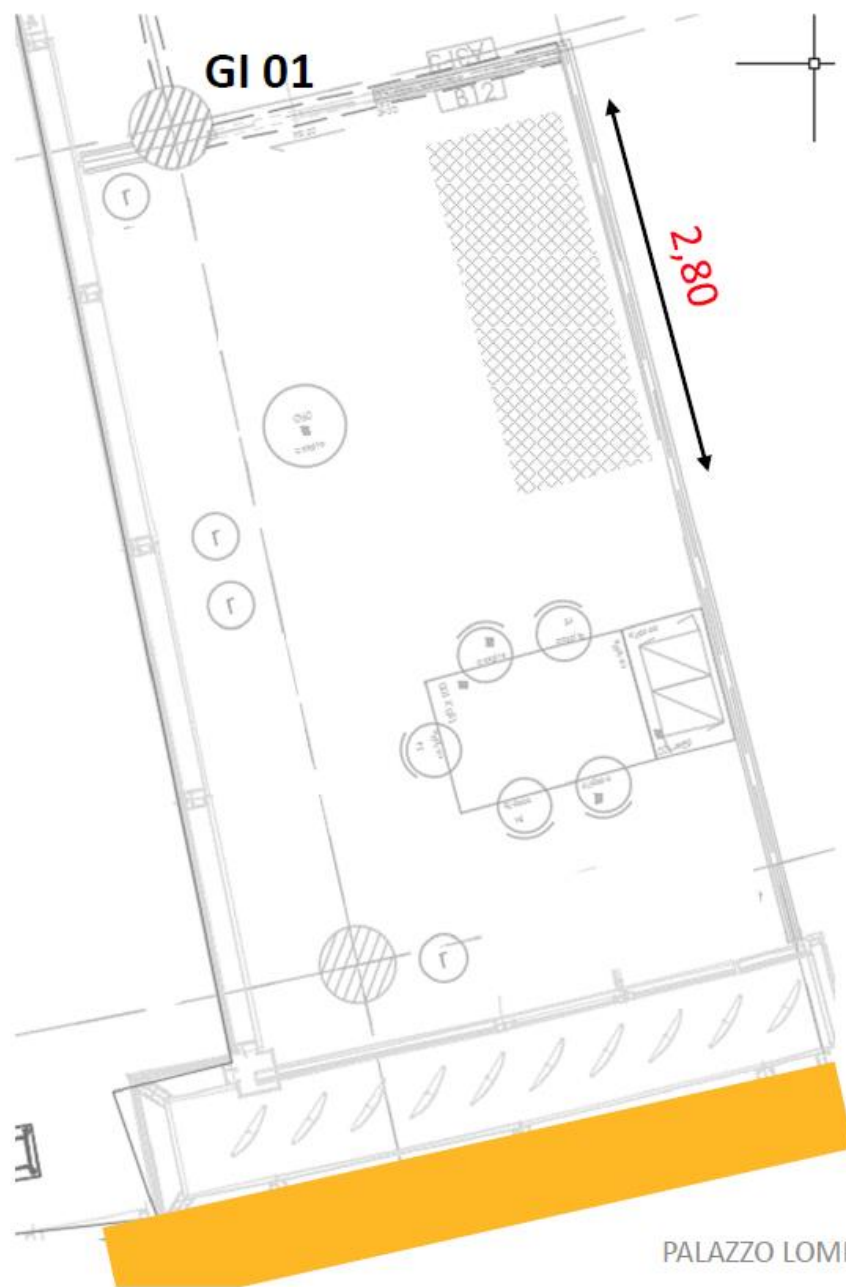

## AREA BREAK **GIALLA**

Piani 7° - 8°

 area per distributori e dispenser

## AREA BREAK **BLU**

Piani 2 - 4°- 6°

 **area per distributori e dispenser**

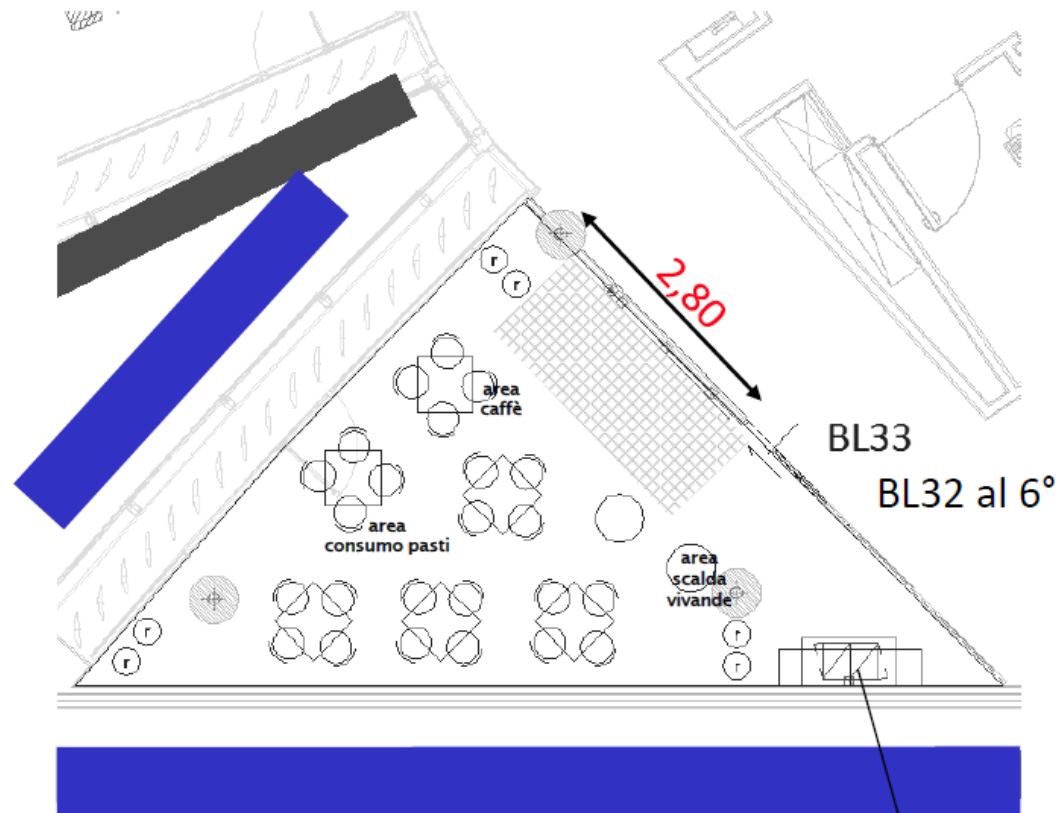

n. 2 microonde sotto  
cappa aspirante

PALAZZO LOMBARDIA

## AREA BREAK **BLU**

Piani 3° - 5° - 8°

 area per distributori e dispenser

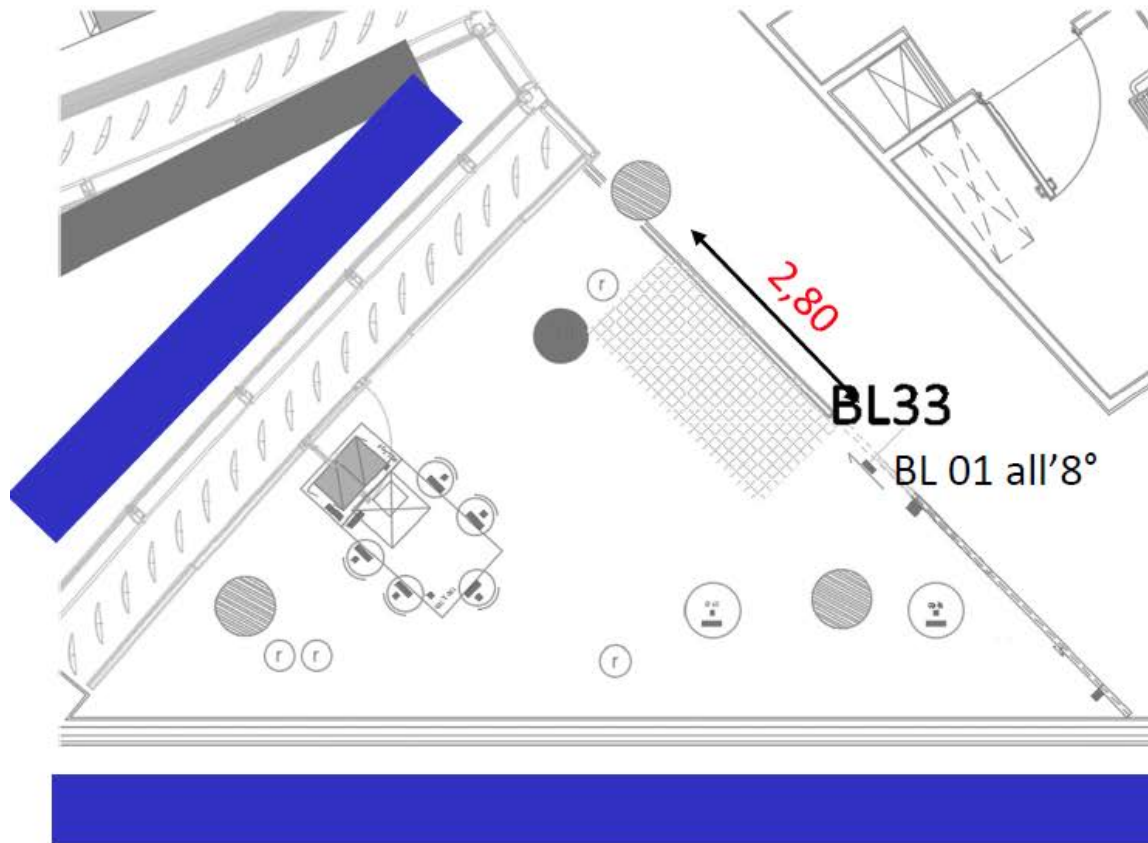

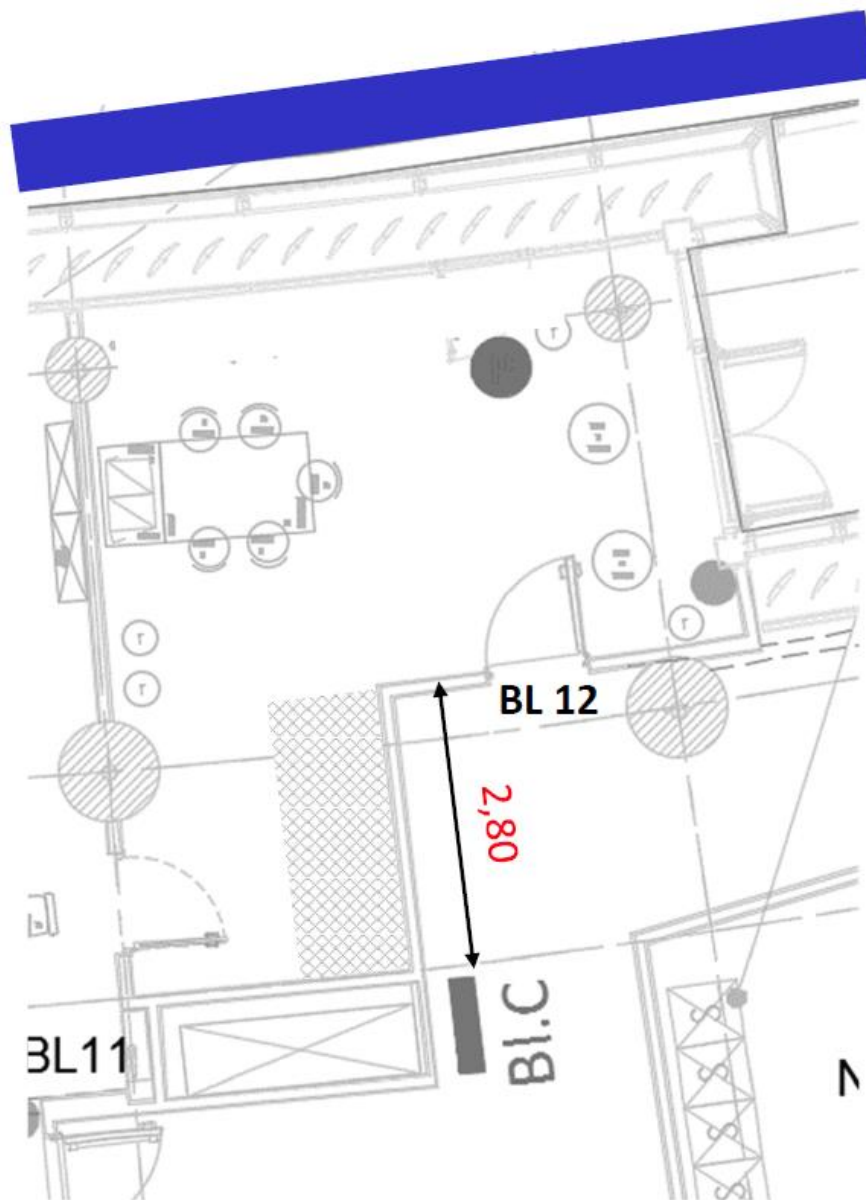

AREA BREAK **BLU**

Piani 7° - 8°

 **area per distributori e dispenser**

PALAZZO LOMBARDIA

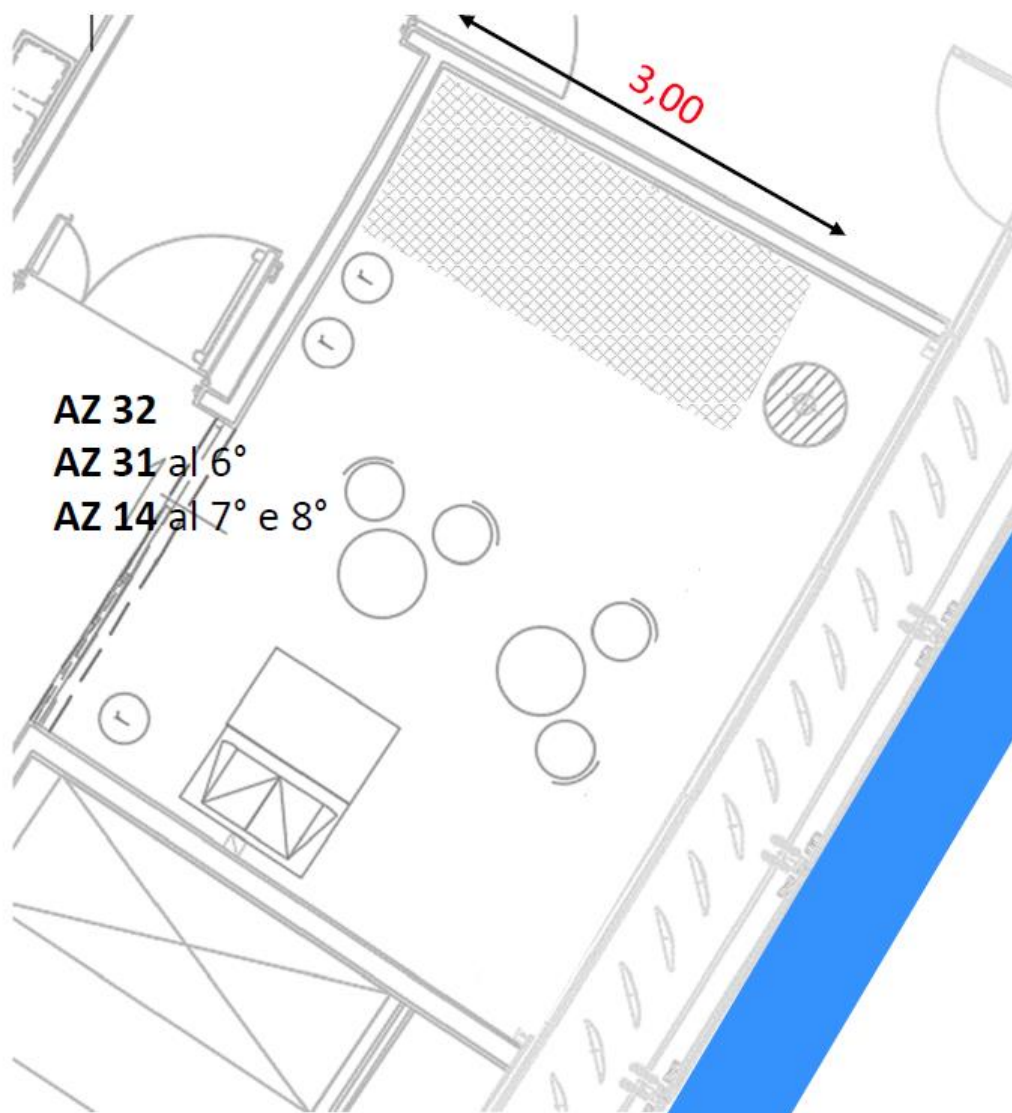

## AREA BREAK **AZZURRA**

Piani 2° - 3° - 4° - 5° - 6° - 7° - 8°

 **area per distributori e dispenser**

## AREA BREAK VERDE

Piani 2° - 3° - 4° - 5° - 6° - 8°

 area per distributori e dispenser

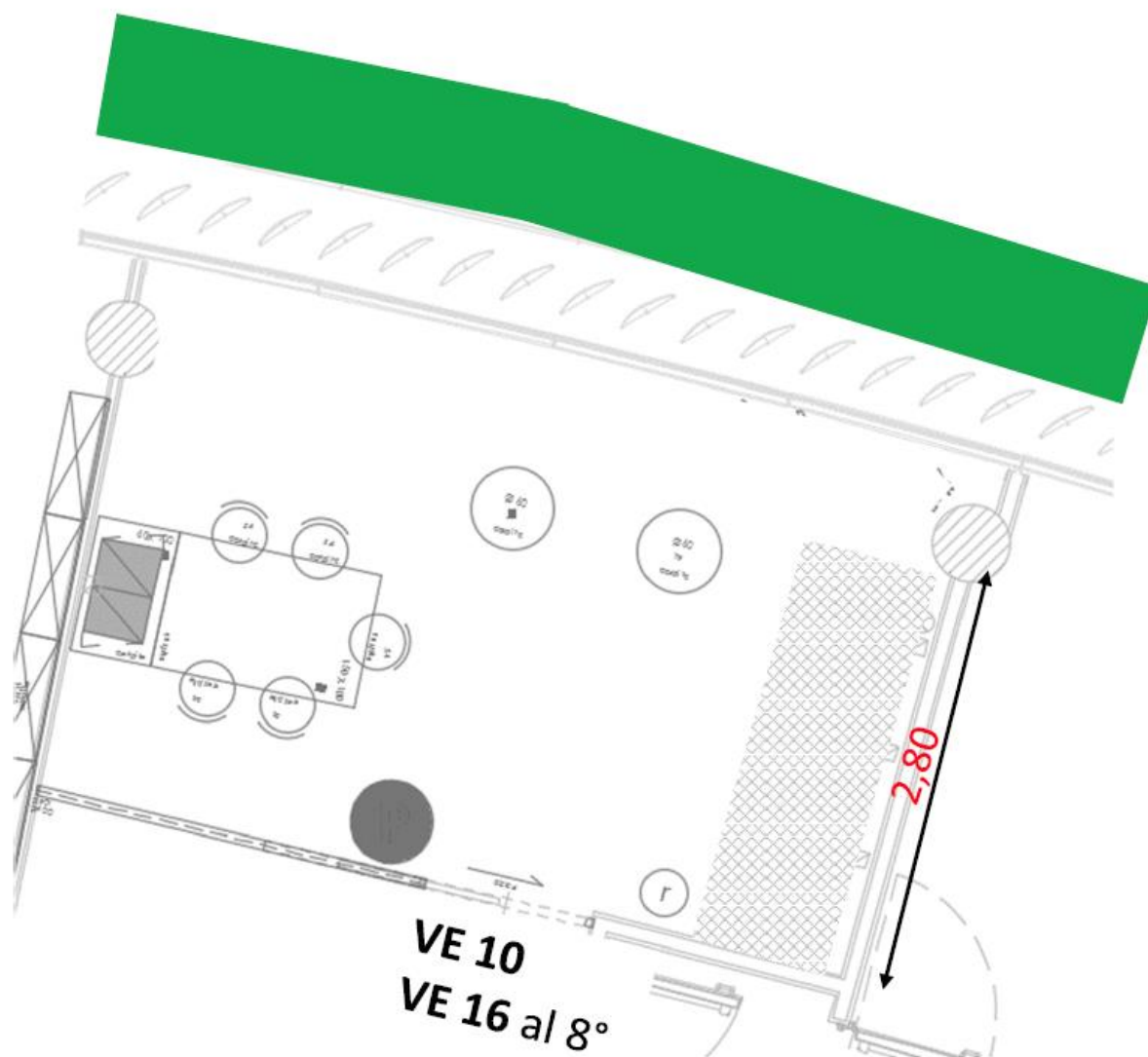

PALAZZO LOMBARDIA



## DISTRIBUZIONE AREE BREAK E DISPENSER NELLA TORRE

MILANO – PALAZZO LOMBARDIA



piano 16°



piani 18° - 20° - 22° - 24° - 26°

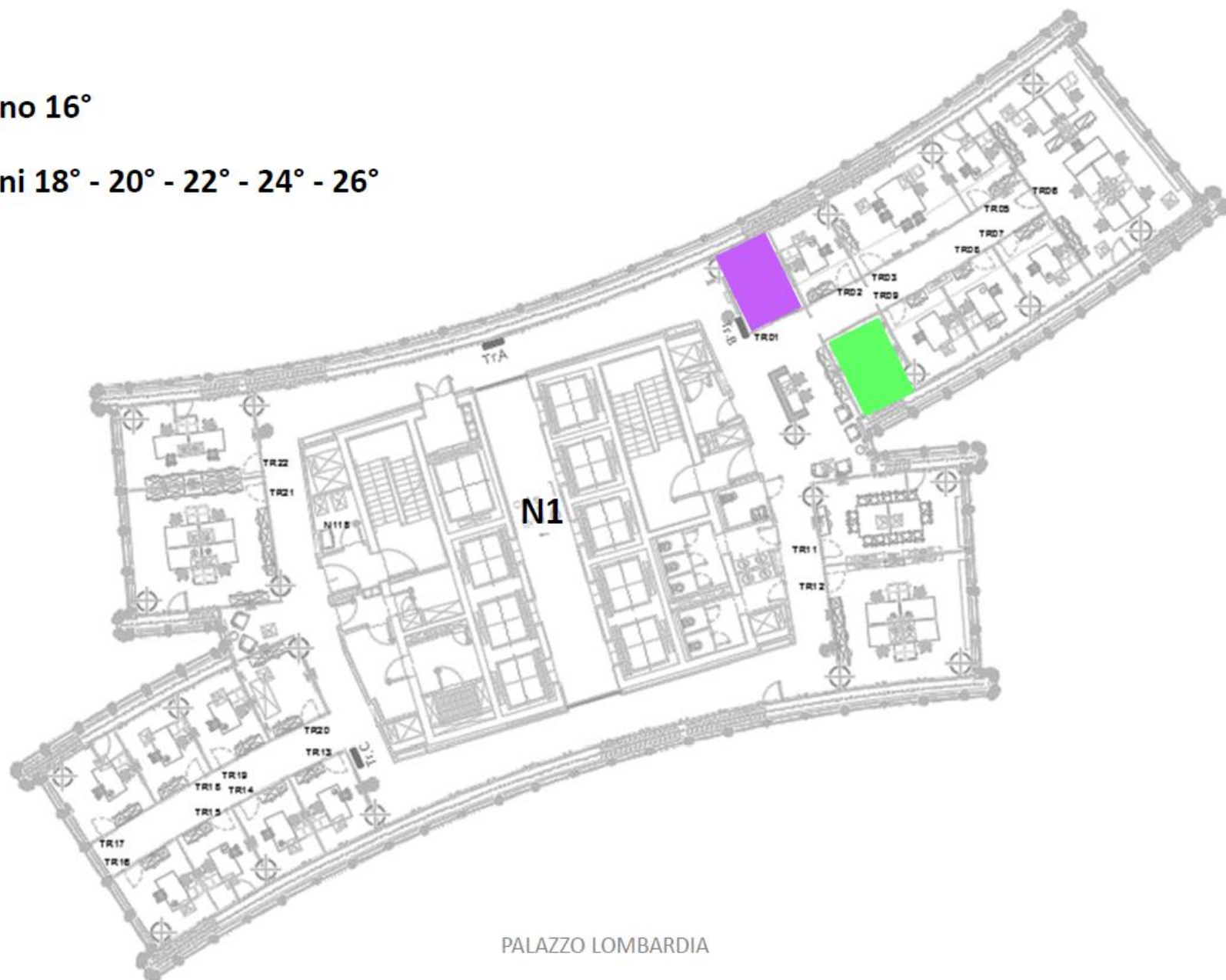

PALAZZO LOMBARDIA

## AREA BREAK **TORRE**

Piano 16°

 **area per distributori e  
dispenser**

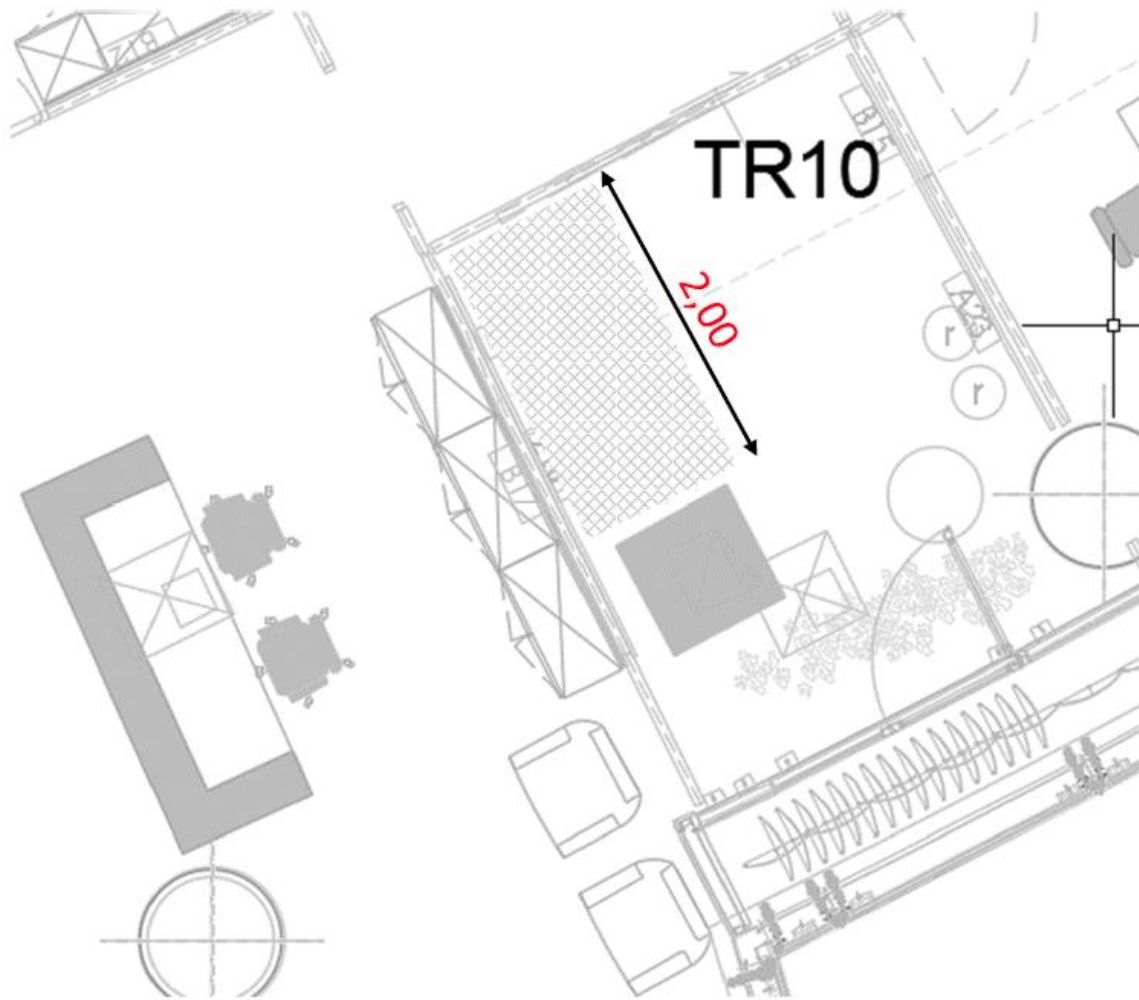

PALAZZO LOMBARDIA



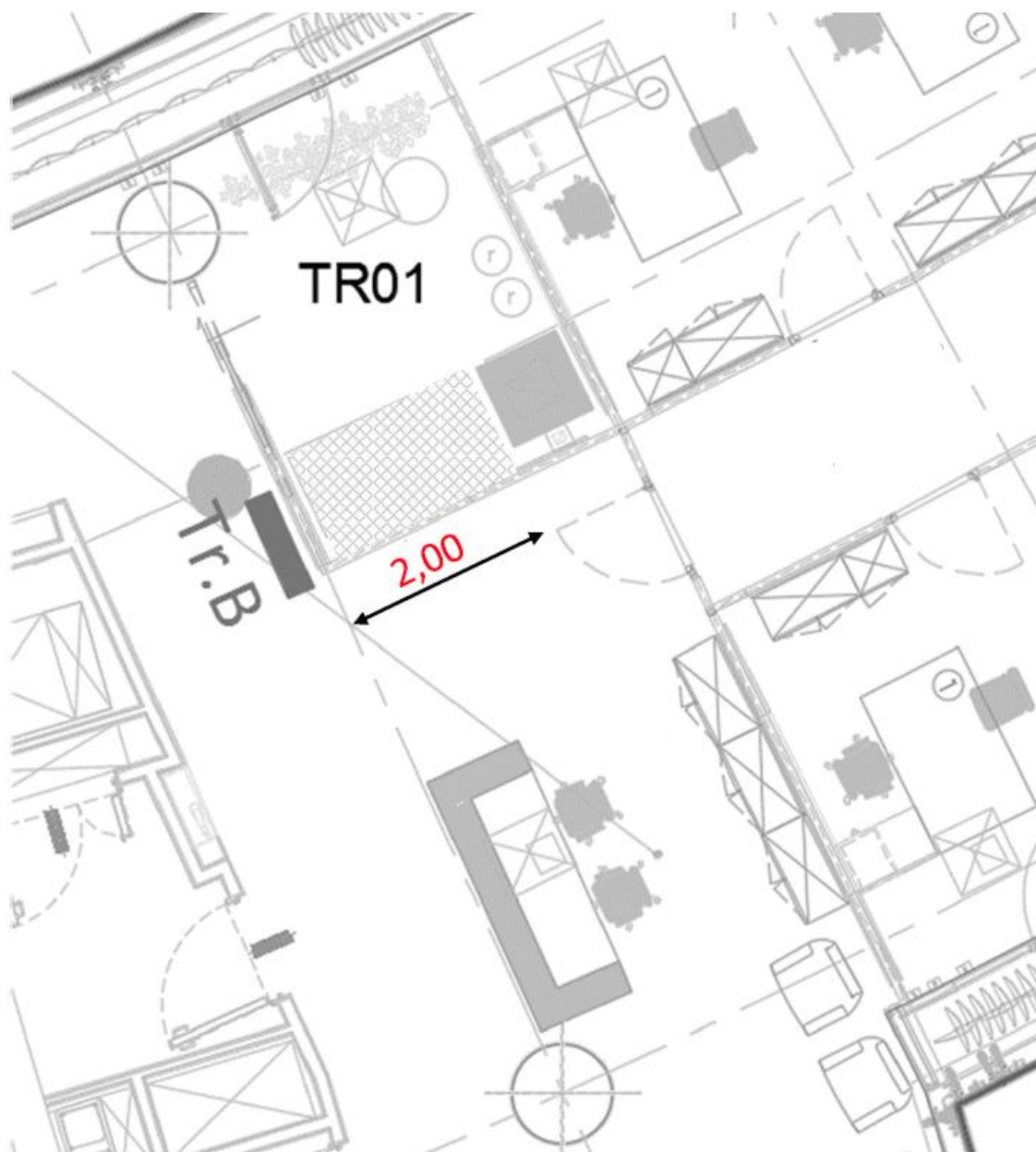

## AREA BREAK **TORRE**

Piano **18° - 20° - 22° - 24° - 26°**

 **area per distributori e dispenser**



## DISTRIBUZIONE DISPENSER ESTERNI ALLE AREE BREAK

MILANO – PALAZZO LOMBARDIA

**piano 13°**



**piano 29°**



**piano 33°**



**piano 35°**

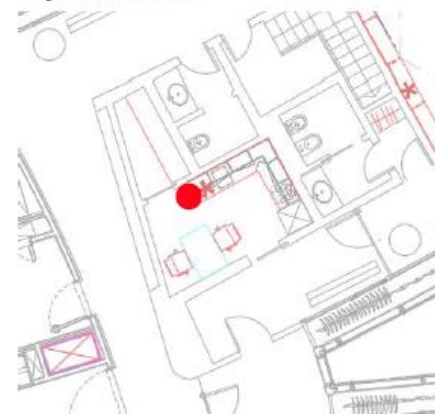

BERGAMO – Via XX Settembre, 18/A

1° piano

area per distributori e  
dispenser

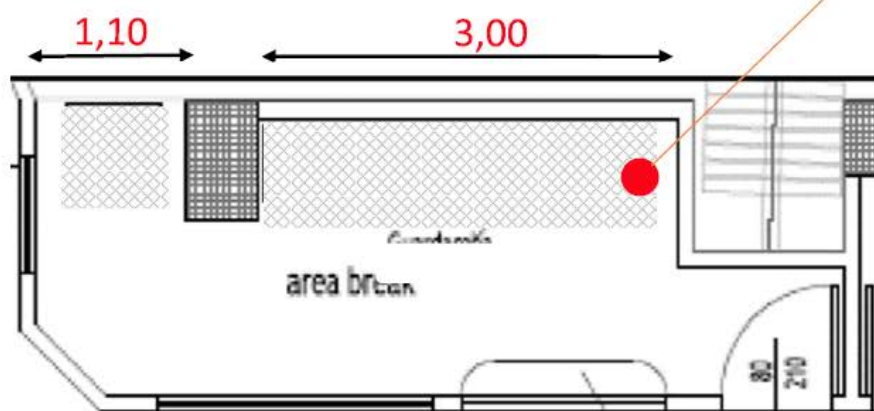
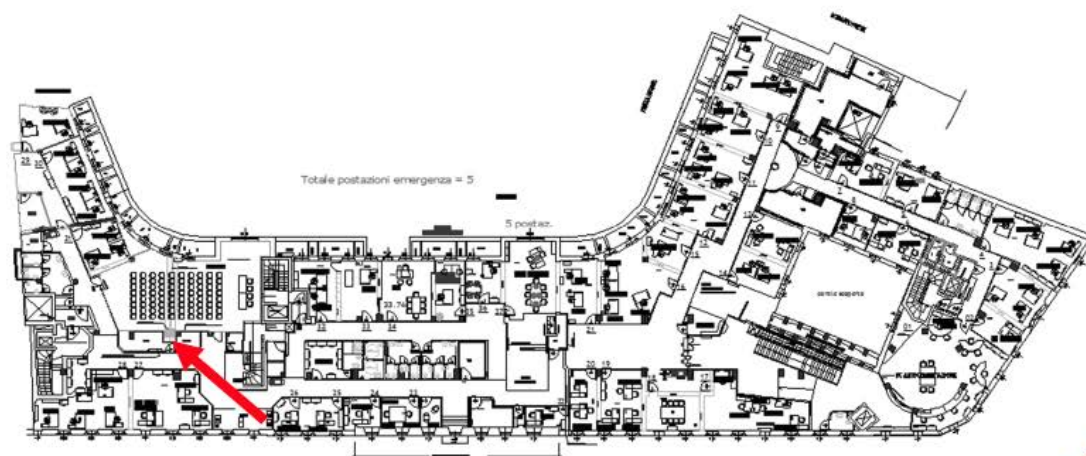

UFFICI TERRITORIALI REGIONALI



BERGAMO – viale Papa Giovanni XXIII  
4° piano

area per distributori

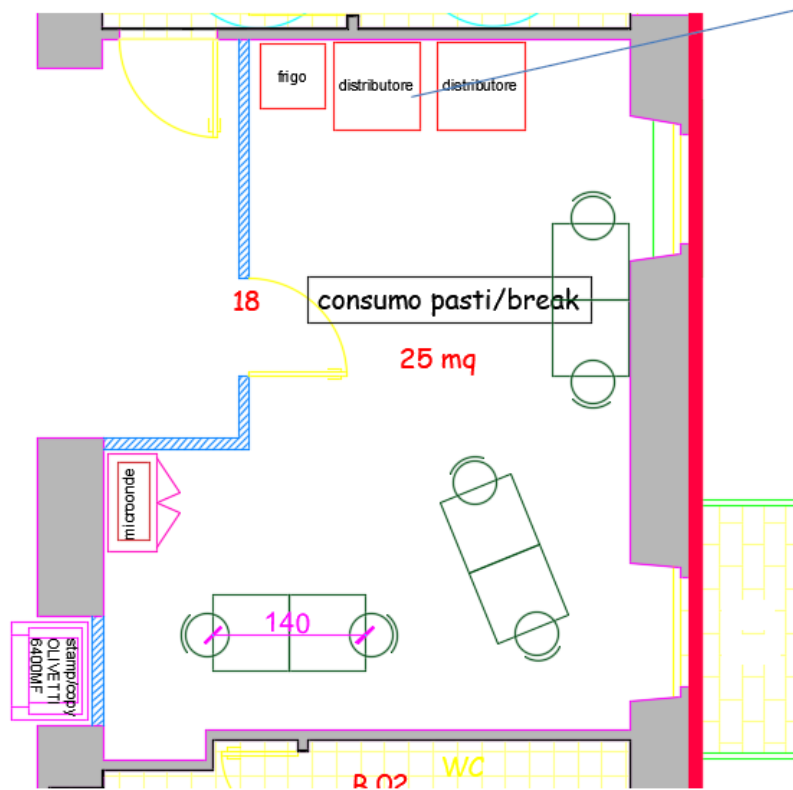

UFFICI TERRITORIALI REGIONALI

BRESCIA - via Dalmazia, 92/94

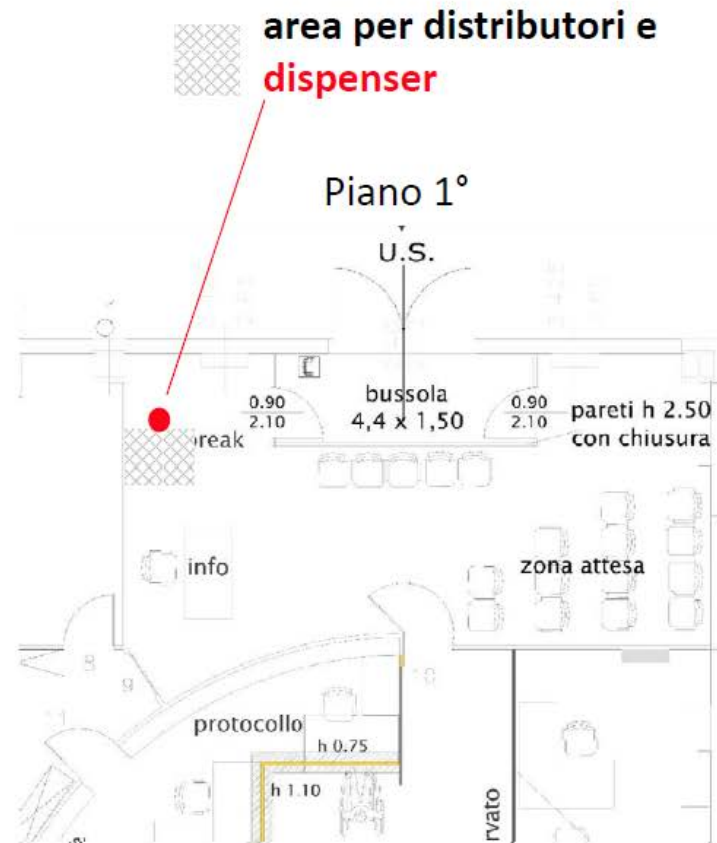

UFFICI TERRITORIALI REGIONALI

 **area per distributori e  
dispenser**

CREMONA  
via Dante, 136

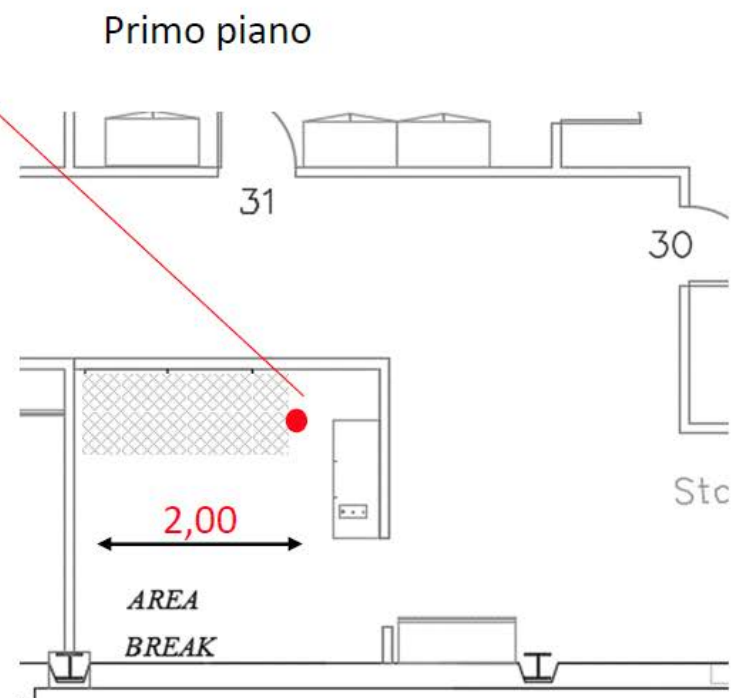

UFFICI TERRITORIALI REGIONALI

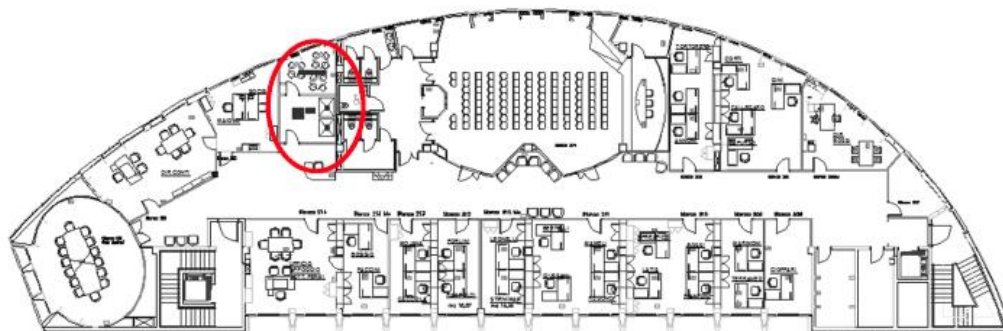

Piano 2° - Regione Lombardia

COMO - Via Einaudi, 1



**area per distributori e  
dispenser**

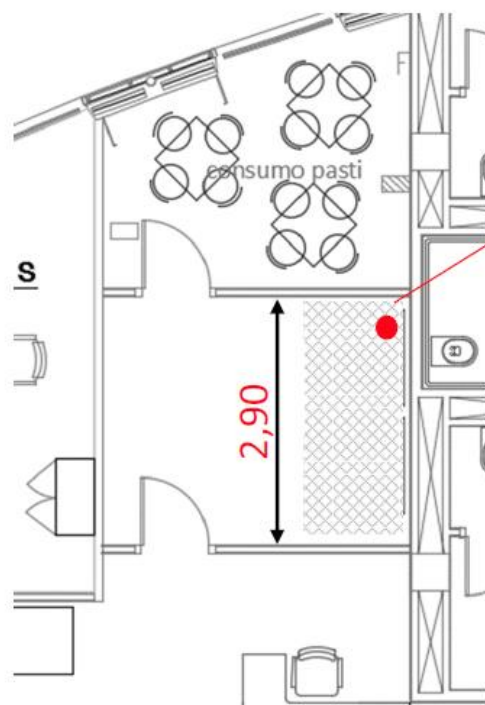

Piano 1° - ARPA

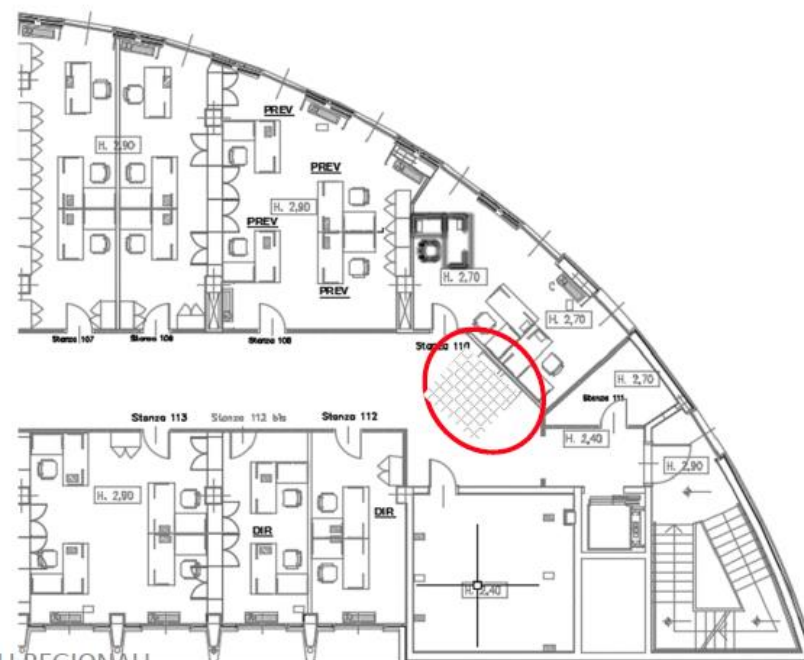

UFFICI TERRITORIALI REGIONALI

LECCO - c.so Promessi Sposi, 132

Piano 1°

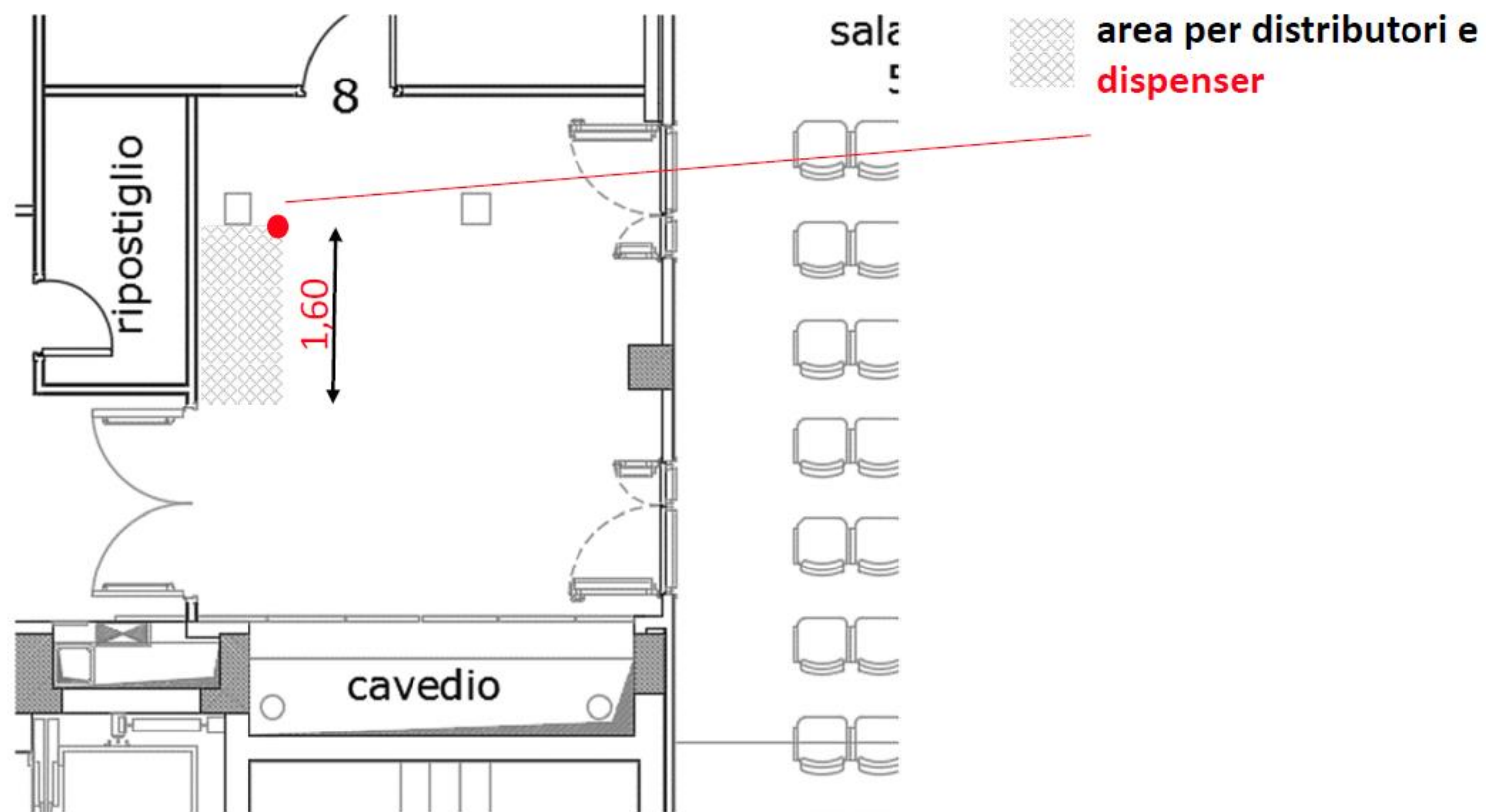

UFFICI TERRITORIALI REGIONALI

PAVIA - Via C. Battisti, 150

Piano terra e 1° piano

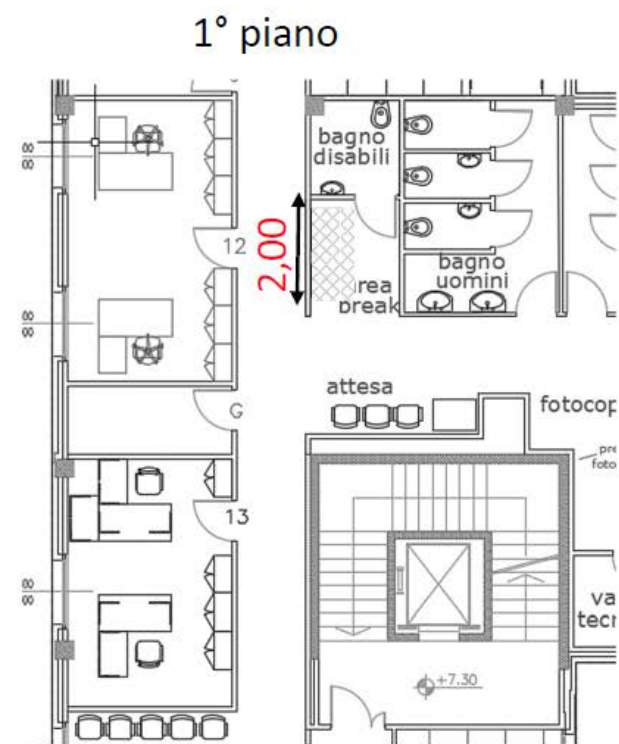
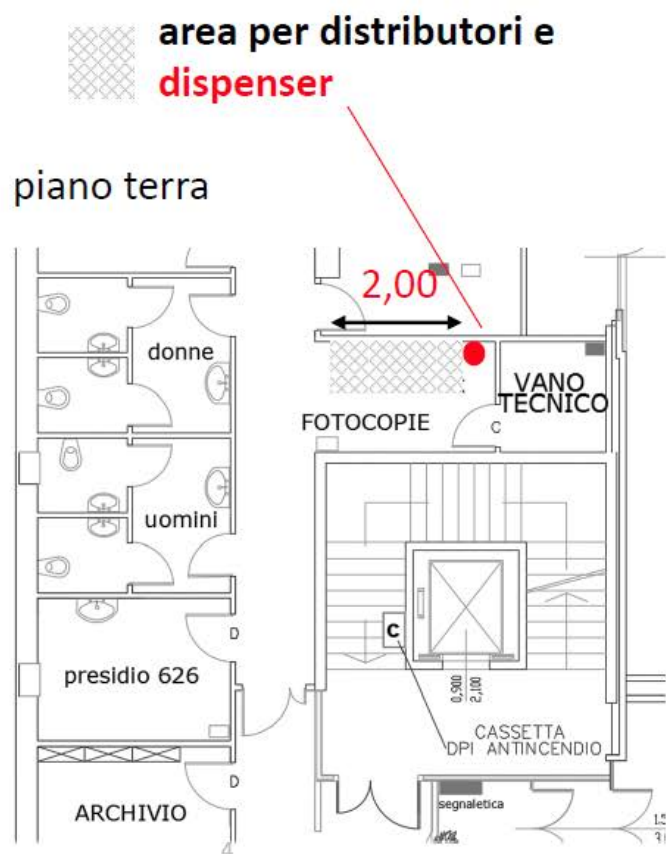

UFFICI TERRITORIALI REGIONALI



SONDRIO - via del Gesù, 17

piano terra

 **area per distributori e  
dispenser**

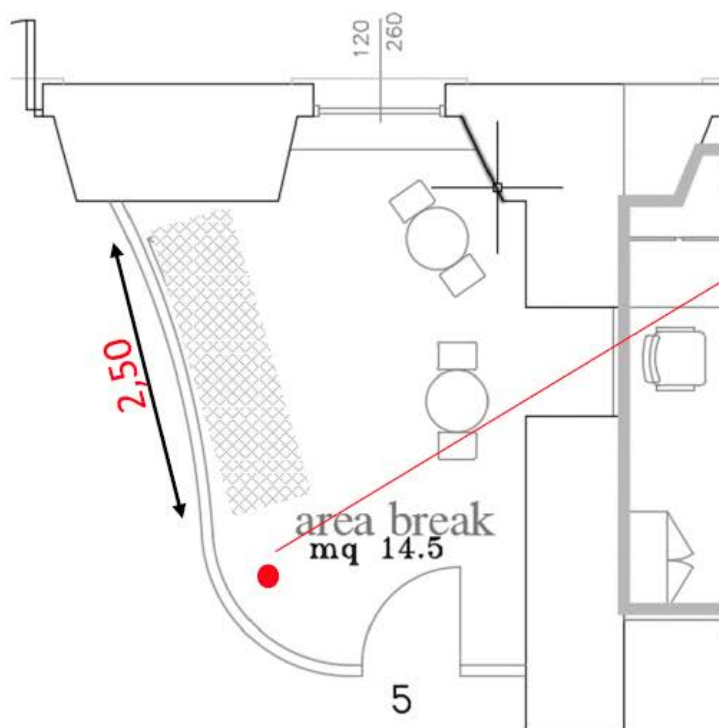

UFFICI TERRITORIALI REGIONALI

VARESE - Via Belforte, 22

2° piano

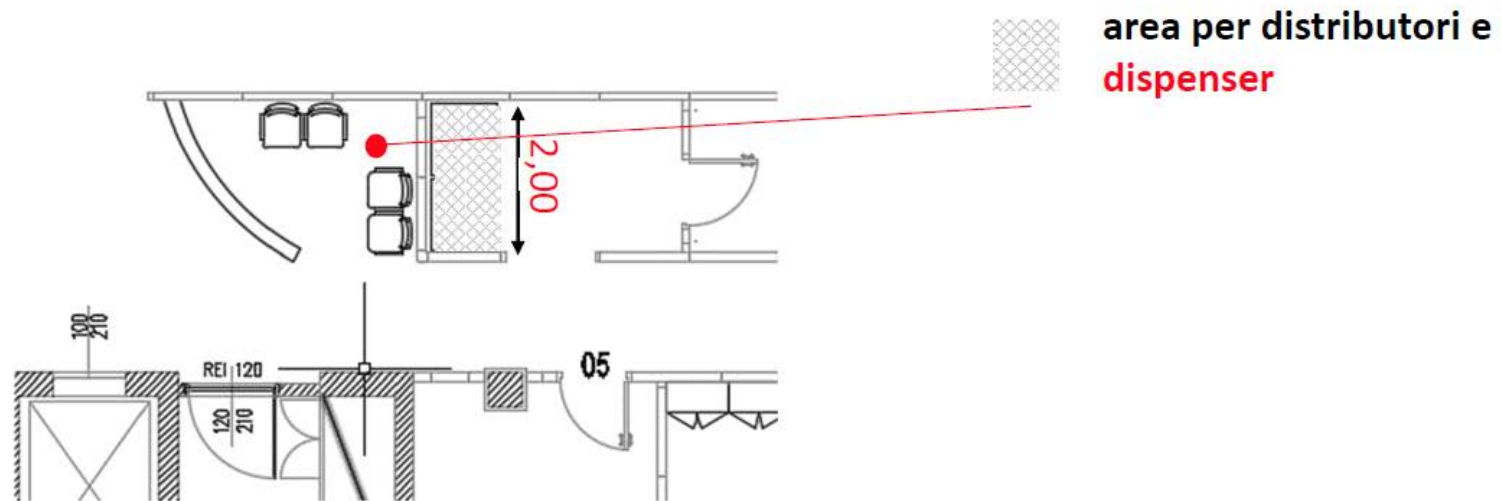

UFFICI TERRITORIALI REGIONALI

ROMA – via Del Gesù, 57

1° piano

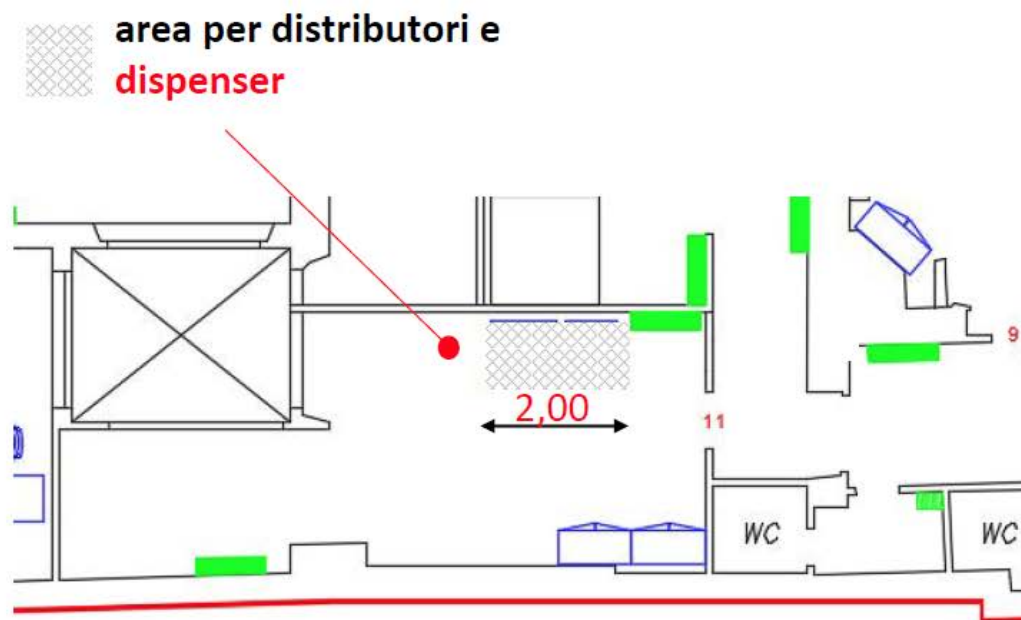

UFFICI TERRITORIALI REGIONALI

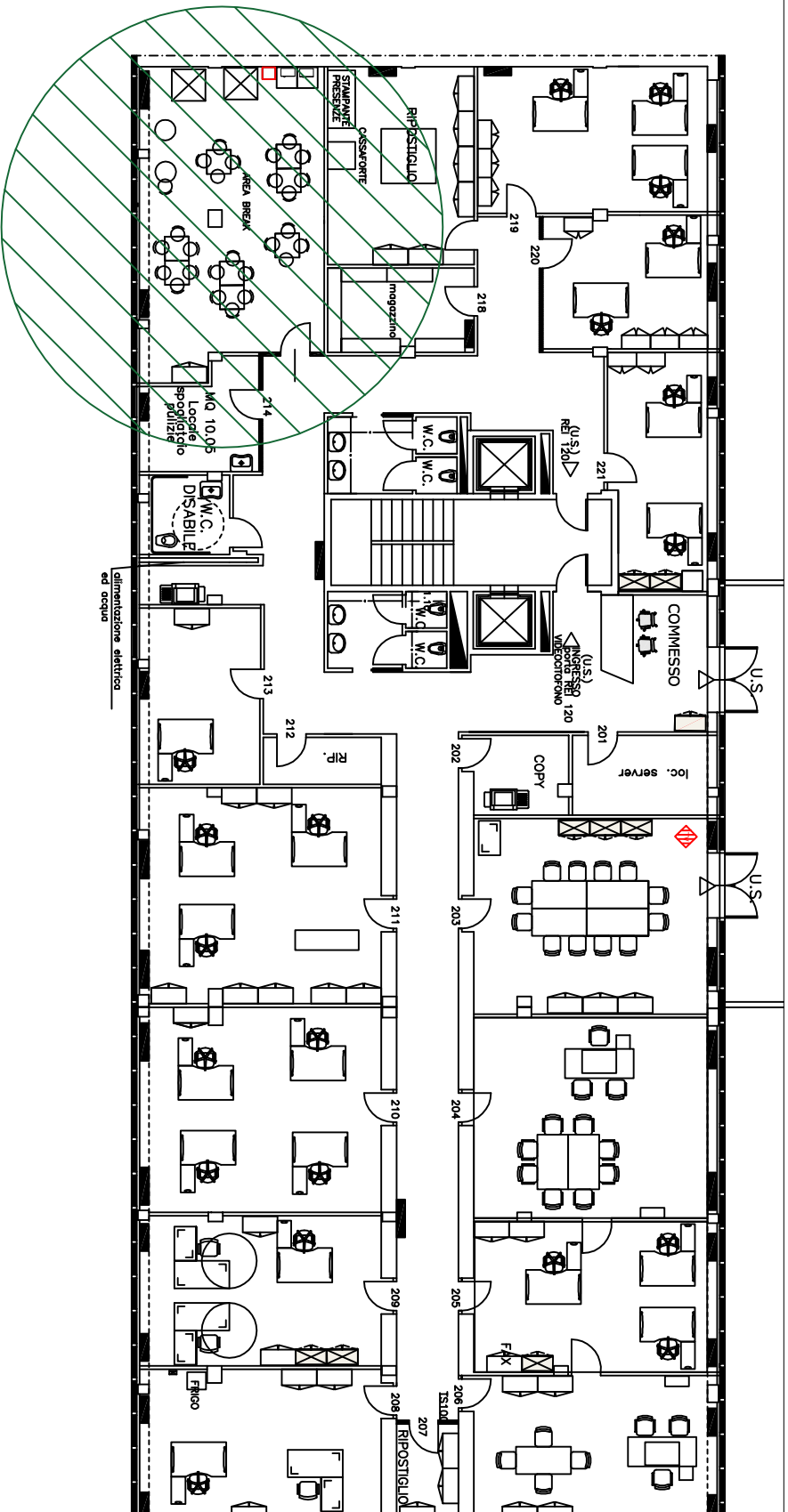

PRIMO PIANO

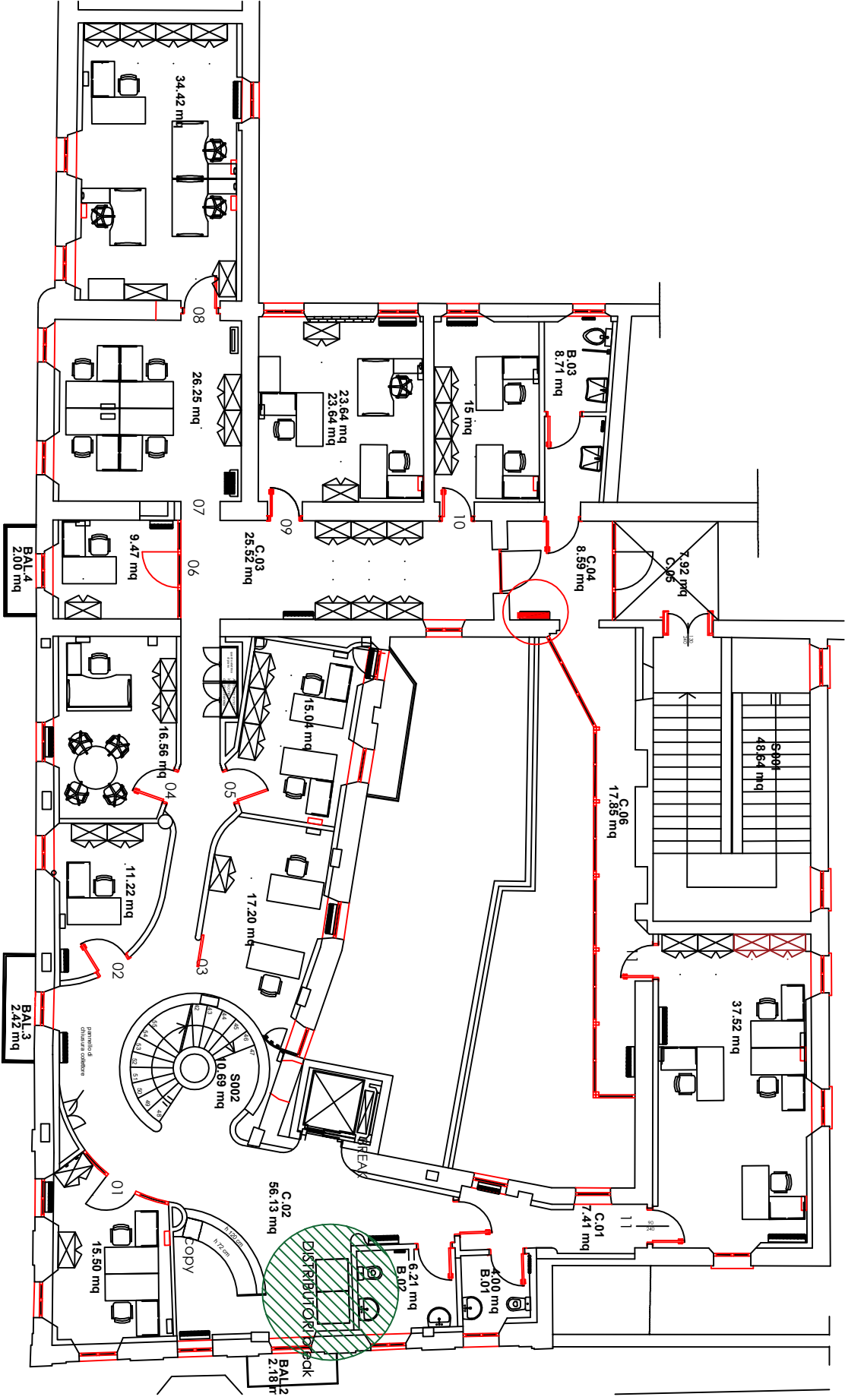



PRIMO PRIMO

